

CERTIFIED RECORD OF LAND CORNER MONUMENTATION

History of original corner establishment:

Corner established by W. B. Barr under GLO contract No. 503 dated May 23, 1884.

Surveyor's General records state:

Set a slatestone 12 x 8 x 8 ins. 8 ins. in the ground for cor to secs 29, 30, 31 and 32 marked with 1 notch on the S and 5 notches on the E edges from which;

- A fir 24 ins diam bears N 4½° E, 130 lks dist mkd T 6 S R 44 E S 29 BT
- A fir 12 ins diam bears N 31° W, 70 lks dist mkd T 6 S R 44 E S 30 BT
- A fir 15 ins diam bears S 50° W, 94 lks dist mkd T 6 S R 44 E S 31 BT
- A fir 12 ins diam bears S 15° E, 104 lks dist mkd T 6 S R 44 E S 32 BT

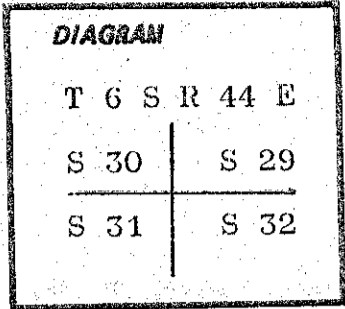

Description of corner evidence found:

All original record bearing trees in good living condition.

Did not find original stone for corner monument.

Description of monument and accessories I established to perpetuate the original location of this corner:

Set a 2½ in. brass cap on a 1 in. iron pipe 31 ins. long and projecting 5 ins. out of the ground with a surrounding rock mound.

Brass cap marked thus: T 6 S R 44 E

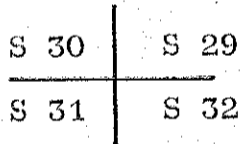

CS 1979

I hereby certify that the above corner monument was properly re-established under my supervision on Nov. 2, 1979 and witnessed by Brad Gordon, Tom Fisk and Jim DeMastus.

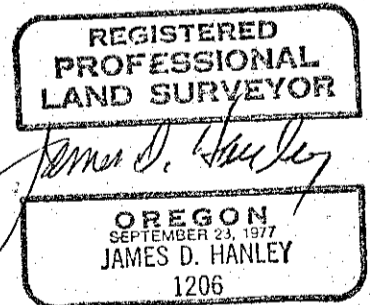

Office of...County...Surveyor..... County of..Baker.....  
 State of..Oregon....., I hereby certify that the within instrument was filed in this office  
 for record on the..5... day of..November... 19...  
 ..... by .....  
 (COUNTY OFFICIAL) (DEPUTY)

Form R6-7100-57 (9/71)

FILED Nov. 5, 1979  
 BAKER COUNTY SURVEYOR  
 SURVEY NO. 6-44-6