

CERTIFIED RECORD OF LAND CORNER MONUMENTATION

History of original corner establishment:

Corner not previously established.

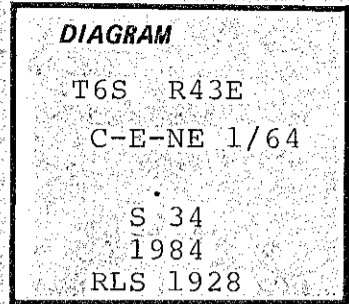

Description of corner evidence found:

Corner not previously established.

Description of monument and accessories I established to perpetuate the original location of this corner:

Set 30" aluminum pipe with a 3 1/4" aluminum cap 5" above ground. Marked as shown above.

Steel post 4' south with signs 54-9 and 54-2.

Scribed:

- 9" Fir "C-E-NE 1/64 S34 BT" S13W 16.4 ft.
- 10" Fir "C-E-NE 1/64 S34 BT" N77E 6.7 ft.

Nailed aluminum washers stamped "PLS 1928" above "BT" scribe on both trees.

Nailed bearing tree signs above blaze and land survey monument signs on back of each tree.

Painted blazes red and a 6" red band on both trees above blaze.

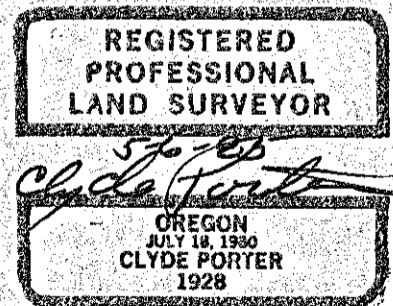

Office of..... County of.....  
 State of....., I hereby certify that the within instrument was filed in this office  
 for record on the..... day of....., 19.....  
 ..... by .....  
 (COUNTY OFFICIAL) (DEPUTY)

FILED May 9, 1986  
 BAKER COUNTY SURVEYOR  
 SURVEY NO. 6-43-103