

CERTIFIED RECORD OF LAND CORNER MONUMENTATION

History of original corner establishment:

Corner not previously established.

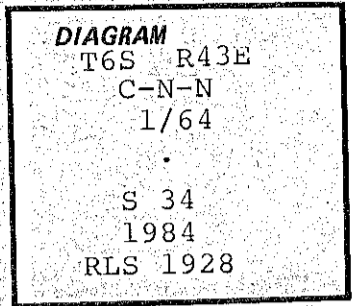

Description of corner evidence found:

Corner not previously established.

Description of monument and accessories I established to perpetuate the original location of this corner:

Set 30" aluminum pipe with 3 1/4" aluminum cap 9" above ground marked as shown above.

Steel post next to cap with signs 54-9 and 54-2.

Scribed:

- 10" Fir "C-N-N 1/64 S34 BT" N51E 24.7 ft.
- 11" Fir "C-N-N 1/64 S34 BT" S56W 38.3 ft.

Nailed aluminum washers stamped "RLS 1928" above "BT" scribe on both trees.

Nailed bearing tree signs above blaze and land survey monument signs on back of each tree.

Painted blazes red and a 6" red band above blaze on each tree.

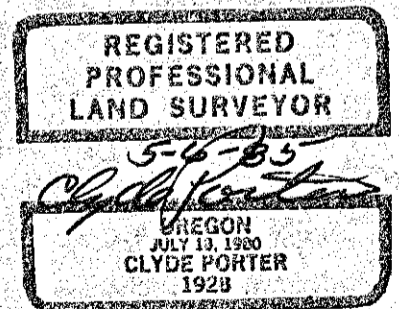

Office of..... County of.....

State of....., I hereby certify that the within instrument was filed in this office

for record on the..... day of....., 19.....

..... by
(COUNTY OFFICIAL) (DEPUTY)

FILED May 9, 1986
BAKER COUNTY SURVEYOR
SURVEY NO. 6-43-99