

CERTIFIED RECORD OF LAND CORNER MONUMENTATION

History of original corner establishment:

Original corner established in 1884 by W. B. Barr under Contract #503.

Corner was a 24" Pine tree marked:  
"T6S R43E S26" on NE side  
"T6S R43E S27" on NW side  
"T6S R43E S34" on SW side  
"T6S R43E S35" on SE side

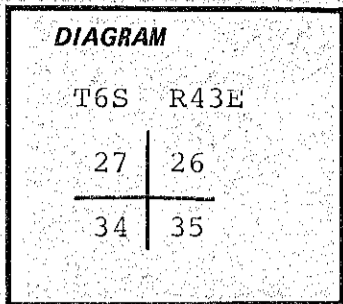

Marked with two notches on the east and one notch on the south edges.

Scribed:

20" Pine N78½E 28 lks  
18" Pine N56W 88 lks  
6" Fir S12W 98 lks  
6" Fir S30½E 80 lks

Description of corner evidence found:

Found:

40" Pine for corner with some markings visible.  
42" Pine in Section 27 - some markings visible.  
32" Pine in Section 34 - with "BT" visible and paint on tree.  
34" Pine in Section 26 - some markings visible and with 54-3 and 54-4 signs attached.  
30" Fir in Section 35 - some markings visible and with 54-3 and 54-4 signs attached.

Description of monument and accessories established to perpetuate the original location of this corner:

Attached 54-3 and 54-9 signs on trees in Sections 27 and 34.

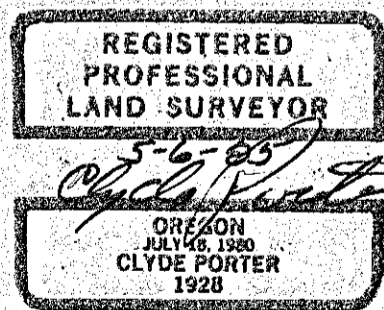

Office of..... County of.....  
State of..... I hereby certify that the within instrument was filed in this office  
for record on the..... day of....., 19.....  
..... by .....

(COUNTY OFFICIAL)

(DEPUTY)

FILED May 9, 1986  
BAKER COUNTY SURVEYOR  
SURVEY NO. 6-43-97