

CERTIFIED RECORD OF LAND CORNER MONUMENTATION

X-Y-24

History of original corner establishment:

Corner established by W. L. Hanley and recorded under Baker County Survey No. 7-44-11, filed October 4, 1978.

Record of survey states:

Set a 5/8 inch x 30 inch rebar.

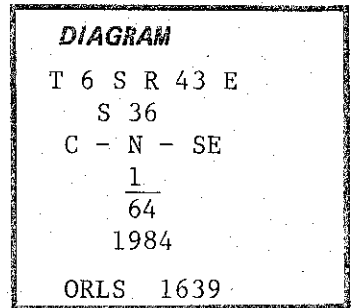

Description of corner evidence found:

Found a 5/8 inch x 30 inch rebar with yellow plastic cap marked R P E 2808.

NOTE: This found rebar bears N30°57'13"E, 2.55 ft dist from corner position established this survey.

Description of monument and accessories established to perpetuate the

original location of this corner on 2" aluminum pipe 31" long buried 27" in ground with 4" proj. from ground with surrounding rock mound and 6' steel fence post alongside with sign 54-9 attached. Buried rebar alongside.

Aluminum cap marked as shown in corner diagram.

New bearing trees established:

A fir 7 ins dia bears N46°W, 12.0 ft marked CNSE1/64S36 BT.

A fir 7 ins dia bears S80°E, 12.7 ft marked CNSE1/64S36 BT.

Each new bearing tree has a brass washer marked PLS 1639 nailed flush with BT blaze and has signs 54-3 and 54-9 attached below a 6 inch band of red paint.

I hereby certify that the above described corner monument was properly established by me on Nov. 15, 1984 and witnessed by Jim DeMastus and Daryl Schuchardt.

Jim DeMastus

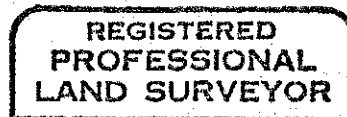

William L. Hanley

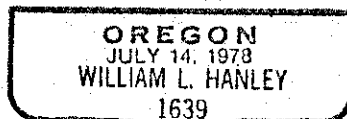

Office of.....County Surveyor..... County of.....Baker.....
State of.....Oregon....., I hereby certify that the within instrument was filed in this office
for record on the..... day of....., 19.....

..... by

(COUNTY OFFICIAL)

(DEPUTY)