

CERTIFIED RECORD OF LAND CORNER MONUMENTATION

History of original corner establishment:

No record of corner being established found in County Surveyors Office.

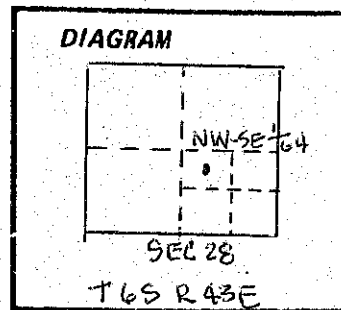

Description of corner evidence found:

None.

Description of monument and accessories I established to perpetuate the original location of this corner.

At the calculated corner position I set a 2" x 30" iron pipe with brass cap marked:

Set monument 24" in ground and surrounded with mound of stone to cap from which:

A 9" Pole Pine bears S 47 1/2° W for 55.0 feet, scribed NW-SE 1/64 S28 BT.

A 12" Aspen bears S 78° W for 63.5 feet, scribed NW-SE 1/64 S28 BT.

BT's have a lower blaze scribed BT with a brass washer stamped PLS 1106 nailed flush. Attached signs 54-3 and painted a red ring around BT's.

Set steel fence post on property line near monument and attached signs 54-2 and 54-9.

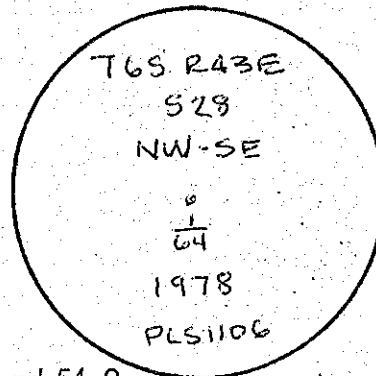

Witness: Les Wilson
Gene Salter

Used magnetic compass with 19 1/2° E declination and measured to center of root crown on BT's with steel tape.

REGISTERED
PROFESSIONAL
LAND SURVEYOR

William R. Wells

OREGON
JULY 22, 1977
WILLIAM R. WELLS
1106

11-1-78

Office of..... County of.....

State of..... I hereby certify that the within instrument was filed in this office

for record on the..... day of....., 19.....

..... by.....
(COUNTY OFFICIAL) (DEPUTY)

FILED Nov. 3, 1978

BAKER COUNTY SURVEYOR
SURVEY NO. 6-43-54