

A: CORNER TO SECTIONS 17, 18, 19, & 20:

NO EVIDENCE OF ORIGINAL MONUMENT FOUND. POSITION ESTABLISHED FROM INTERSECTION OF RECORD BEARINGS FROM FOUND ORIGINAL BEARING TREES. MONUMENT SET 22" IN GROUND WITH MOUND OF STONE TO CAP, CAP MARKED:

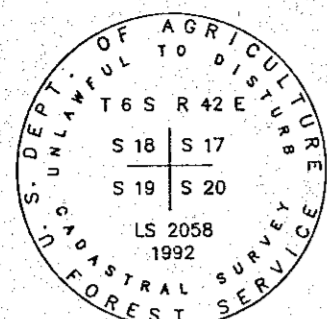

FROM WHICH G.L.O. ACCESSORIES:
A FIR, 36" [20"] IN DIAM. BEARS S 75° W [S 75° W], 26.21' [25.7'] MARKED WITH PARTIALLY OPEN BLAZE.
A ROTTED PINE STUMP, 29" [20"] IN DIAM. BEARS S 72° E [S 72° E], 8.95' [8.6'] NO BLAZE VISIBLE.
A PINE, 33" [22"] IN DIAM. BEARS N 36° E [N 36° E], 22.75' [15.2'] BLAZE OPEN AND SCRIBING VISIBLE.
A 28" [18"] PINE, DEAD AND DOWN BEARS N 60° W [N 60° W], 67.3' [67.3']

FROM WHICH LS2058 ACCESSORIES:

A FIR, 13" DIAM. BEARS N 80° 53' W, 18.94', SCRIBED "T6SR42ES18BT".
A FIR, 17" DIAM. BEARS N 45° 33' W, 29.00', SCRIBED "T6SR42ES18BT".
A FIR, 9" DIAM. BEARS S 33° 32' E, 40.58', SCRIBED "T6SR42ES20BT".

B: 1/4 CORNER TO SECTIONS 17 & 20:

FOUND EVIDENCE OF OLD STONE IN A MOUND OF STONE, NO MARKINGS VISIBLE. SET MONUMENT 25" IN GROUND WITH MOUND OF STONE TO CAP, AND BURIED STONE TO WEST.

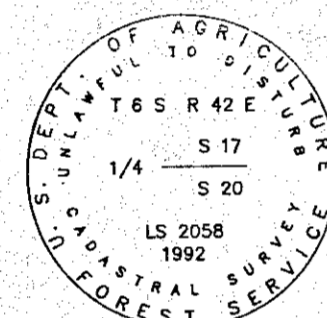

FROM WHICH G.L.O. ACCESSORIES:

A PINE STUMP, 36" [22"], 12" HIGH BEARS N 71° W [N 71° W], 38.6' [37.6'], MARKED WITH OPEN BLAZE SCRIBED "T".

FROM WHICH LS2058 ACCESSORIES:

A FIR, 9" DIAM. BEARS N 43° 23' W, 59.49', MKD. T6SR42ES17BT
A FIR, 10" DIAM. BEARS S 36° 31' W, 17.61', MKD. T6SR42ES20BT
A PINE, 15" DIAM. BEARS S 79° 26' E, 32.39', MKD. T6SR42ES20BT
A PINE, 17" DIAM. BEARS N16° 05' E, 23.30', MKD. T6SR42ES17BT

C: CORNER TO SECTIONS 16, 17, 20 & 21:

FOUND A 2 1/2" BRASS CAP MONUMENT, 6" ABOVE GROUND IN A 2 1/2" DIAM. MOUND OF STONE. CAP MARKED:

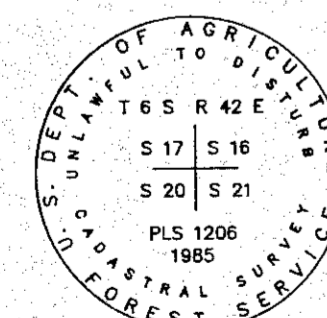

FROM WHICH G.L.O. ACCESSORIES:

A PINE STUMP, 24" [24"] [20"] DIAM. BEARS N60°E [N58°E] {N58°E}, 56.52' [56.1'] [56.8'], SCRIBED "BT" VISIBLE.

FROM WHICH LS1206 ACCESSORIES:

A DEAD PINE, 12" [12"] DIAM. BEARS S41°18'E {S43°E}, 40.72' [40.8'], SCRIBED T6SR42ES21BT
A PINE, 9" [9"] DIAM. BEARS S6°24'W {S4°W}, 17.50' [17.8'], SCRIBED T6SR42ES20BT
A PINE, 9" [10"] DIAM. BEARS N48°W {N38°W}, 5.38' [5.2'], SCRIBED T6SR42ES17BT
A PINE, 10" [10"] DIAM. BEARS N65°44'E {N63°E}, 12.50' [12.5'], SCRIBED T6SR42ES16BT

D: 1/4 CORNER TO SECTIONS 20 & 21:

NO EVIDENCE OF ORIGINAL MONUMENT FOUND. POSITION ESTABLISHED AT RECORD BEARING AND DISTANCE FROM REMAINS OF 22" BURNT PINE LOG AND ROOT HOLE. MONUMENT SET 20" IN GROUND AND CAP MARKED:

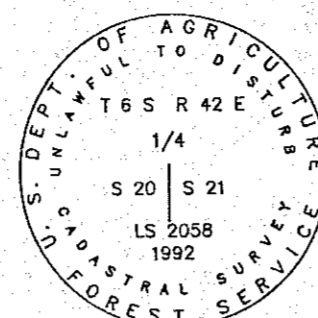

FROM WHICH G.L.O. ACCESSORIES:

A BURNT PINE LOG AND ROOT HOLE, 22" [16"] DIAM. BEARS S48°E [S48°E], 120.10' [120.1'] NO SCRIBING VISIBLE.
A BURNT PINE LOG, 24" [14"] DIAM. BEARS S09°W [S09°W], 142.6' [142.6'], NO SCRIBING VISIBLE.

FROM WHICH LS2058 ACCESSORIES:

A PINE, 12" DIAM. BEARS N20°46'E, 20.23'
A PINE, 9" DIAM. BEARS S07°43'E, 93.85'
A PINE, 9" DIAM. BEARS S78°57'E, 62.45'
A 3/4" DRILL HOLE IN N-S LEDGE ROCK BEARS N52°01'W, 68.38'

E: CORNER TO SECTIONS 20, 21, 28, & 29:

NO EVIDENCE OF ORIGINAL MONUMENT FOUND. POSITION ESTABLISHED USING RECORD BEARING AND DISTANCE FROM FOUND ORIGINAL BEARING TREE STUMP. MONUMENT SET 2" IN GROUND WITH MOUND OF STONE TO CAP, CAP MARKED:

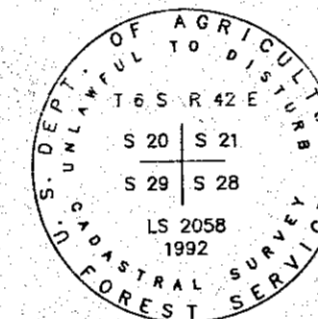

FROM WHICH G.L.O. ACCESSORIES:

A PINE STUMP, 20" [15"] DIAM. BEARS S16°E [S16°E], 56.10' [56.1'], SCRIBING VISIBLE IN BLAZE.
A LOG/ROOT HOLE, 26" [26"] DIAM. BEARS N75°E [N75°E], 47.5' [47.5']

FROM WHICH LS2058 ACCESSORIES:

A CHISELED HOLE, BEARS N27°54'W, 92.54'
A CHISELED HOLE, BEARS S18°21'E, 44.88'
A PINE, 7" DIAM. BEARS N77°31'W, 90.43', SCRIBED XBT
A PINE, 15" DIAM. BEARS N77°59'E, 61.57', SCRIBED T6SR42ES21BT

F: 1/4 CORNER TO SECTIONS 20 & 29:

FOUND A STONE, 12"x8"x6" [12X8X6], IN A SMALL MOUND OF STONE, MARKED 1/4 ON NORTH FACE. SET MONUMENT 24" IN GROUND AT POSITION OF MARKED STONE AND BURIED MARKED STONE TO SOUTH, CAP MARKED:

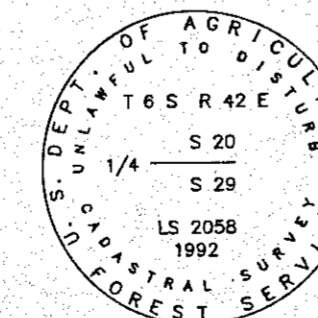

FROM WHICH G.L.O. ACCESSORIES:

A PINE STUMP, 30" [30"] DIAM. BEARS S08°59'E [S10°30'E], 97.56' [97.0'], PARTIAL BLAZE VISIBLE

FROM WHICH LS2058 ACCESSORIES:

A PINE, 15" DIAM. BEARS S06°12'W, 53.71', SCRIBED T6SR42ES29BT
A PINE, 14" DIAM. BEARS N80°06'W, 59.83', SCRIBED T6SR42ES20BT
A PINE, 7" DIAM. BEARS N25°09'W, 24.74', SCRIBED T6SR42ES20BT
A PINE, 15" DIAM. BEARS N59°58'E, 86.15', SCRIBED T6SR42ES20BT

G: CORNER TO SECTIONS 19, 20, 29, & 30:

FOUND A STONE, 12"x12"x8" [12X12X6], WITH 2 NOTCHES ON SOUTH AND 5 NOTCHES ON EAST. SET MONUMENT 20" IN GROUND AND BURIED MARKED STONE TO EAST. CAP MARKED:

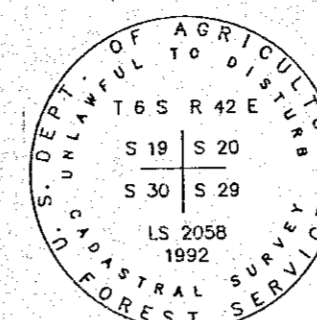

FROM WHICH LS2058 ACCESSORIES:

SET 1/2" REBAR BEARS S88°02'E, 26.71'
SET 1/2" REBAR BEARS S14°03'W, 24.15'
CHISELED X IN ROCK BEARS N88°12'W, 23.17'
SET 1/2" REBAR BEARS N12°40'E, 21.27'

H: 1/4 CORNER TO SECTIONS 19 & 20:

NO EVIDENCE OF ORIGINAL MONUMENT FOUND. SET MONUMENT FROM FOUND ORIGINAL BEARING TREES. SET MONUMENT 26" IN GROUND WITH MOUND OF STONE TO CAP. CAP MARKED:

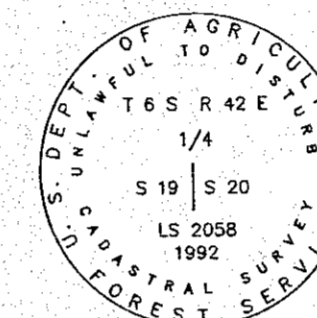

FROM WHICH G.L.O. ACCESSORIES:

A PINE STUMP, 42" [26"] DIAM. BEARS N28°23'W [N25°W], 14.89' [18.5'], BLAZE AND SCRIBING VISIBLE
A PINE, DEAD AND DOWN, 24" [22"] DIAM. BEARS N47°27'E [N48°E], 21.68' [21.1'], BLAZE AND FAINT SCRIBING VISIBLE

FROM WHICH LS2058 ACCESSORIES:

A FIR, 12" DIAM. BEARS N71°34'E, 41.56', SCRIBED T6SR42ES20BT
A FIR, 12" DIAM. BEARS S23°21'E, 18.76', SCRIBED T6SR42ES20BT
A FIR, 12" DIAM. BEARS S50°13'W, 37.67', SCRIBED T6SR42ES19BT
A FIR, 10" DIAM. BEARS N50°07'W, 68.80', SCRIBED T6SR42ES19BT

I: CENTER 1/4 CORNER TO SECTION 20:

MONUMENT SET 26" IN GROUND WITH MOUND OF STONE TO CAP. CAP MARKED:

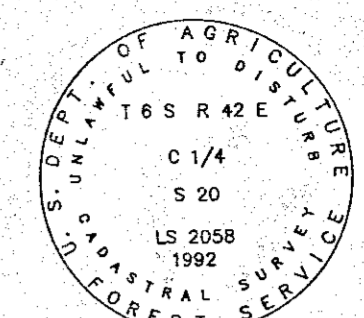

FROM WHICH LS2058 ACCESSORIES:

A TAMARACK, 10" DIAM. BEARS N16°25'E, 1.32' SCRIBED C1/4S20BT
A PINE, 6" DIAM. BEARS N71°52'E, 18.01', SCRIBED C1/4S20BT
A FIR, 17" DIAM. BEARS S13°09'E, 37.04', SCRIBED C1/4S20BT
A FIR, 11" DIAM. BEARS N85°16'W, 26.88', SCRIBED C1/4S20BT

J: CENTER EAST 1/16 CORNER SECTION 20:

MONUMENT SET 26" IN GROUND WITH MOUND OF STONE TO CAP. CAP MARKED:

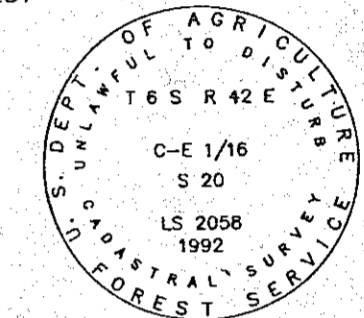

FROM WHICH LS2058 ACCESSORIES:

A PINE, 7" DIAM. BEARS N27°49'E, 6.17', SCRIBED CE1/16S20BT
A PINE, 17" DIAM. BEARS S73°32'E, 8.83', SCRIBED CE1/16S20BT

NOTES

BEARINGS TO BEARING TREES WERE TAKEN TO A NAIL AND BRASS TAG, MARKED LS 2058, PLACED AT THE BASE OF THE FRONT FACE OF THE TREE OR ABOVE THE "B" IN "BT" IN THE BLAZE. DISTANCES WERE TAKEN TO 16d GALVANIZED NAIL IN THE SIDE CENTER BASE OF THE BEARING TREES.

MONUMENT = A 3" DIAM. U.S.F.S. ALUMINUM CAPPED PIPE, 30" LONG, WITH MAGNET

- [] RECORD BEARING AND/OR DISTANCE, G-L-O, 1883
- () RECORD BEARING AND/OR DISTANCE, MS 938, 1955
- { } RECORD BEARING AND/OR DISTANCE, LS1206

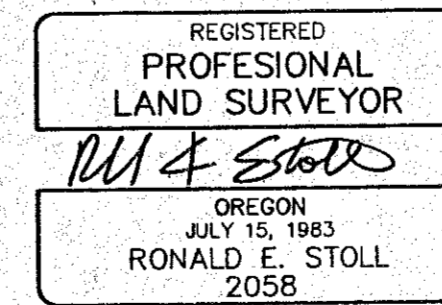

RONALD E. STOLL, R.L.S. 2058

JOB NO. 1210-691-OR
CONTRACT NO. 53-04M3-1-0113
SHEET 4 OF 5

A PORTION OF
SECTIONS 20 AND 21
T 6 S R 4 2 E W.M.
BAKER COUNTY, OREGON
RECORD OF SURVEY
RES LAND SURVEYS, INC. 8335 PLACITA DADIVOSO
TUCSON, ARIZONA 85704

FILED: May 26, 1993
BAKER COUNTY SURVEYOR
SURVEY NO. 6-42-2 (5 sheets)