

Surveyed for John Johnson & Ed Remillard June 14, 1885

By J.W. Kimbrell Dept. Co. Surveyor Plat No 36

For the Re-establishment of the corner to Sec 1 & 12 and 6 & 7 on the Guide Meridian or Auxiliary meridian between 1/4 S Ranges 39 & 40 E 10th and the 1/4 Sec corners on West side of Sec 6 & 7 in T48 R40 E40th and the establishing of the 1/4 corner on West side of Sec 7.

I started at the NW corner Sec 6 thence South over 20° E at 40 chains set post for temporary 1/4 sec. cor on west side Sec 6. at 80 chains set stake for support corner to Sec 1-12-6 & 7 and at thence South at 40 chains set stake for temporary 1/4 sec. cor at 60 chains set stake for temporary 1/2 corner and at 8054 chains the corner to Sec 7-12-12 & 13 making an excess of 54 links in the 2 miles I therefore run

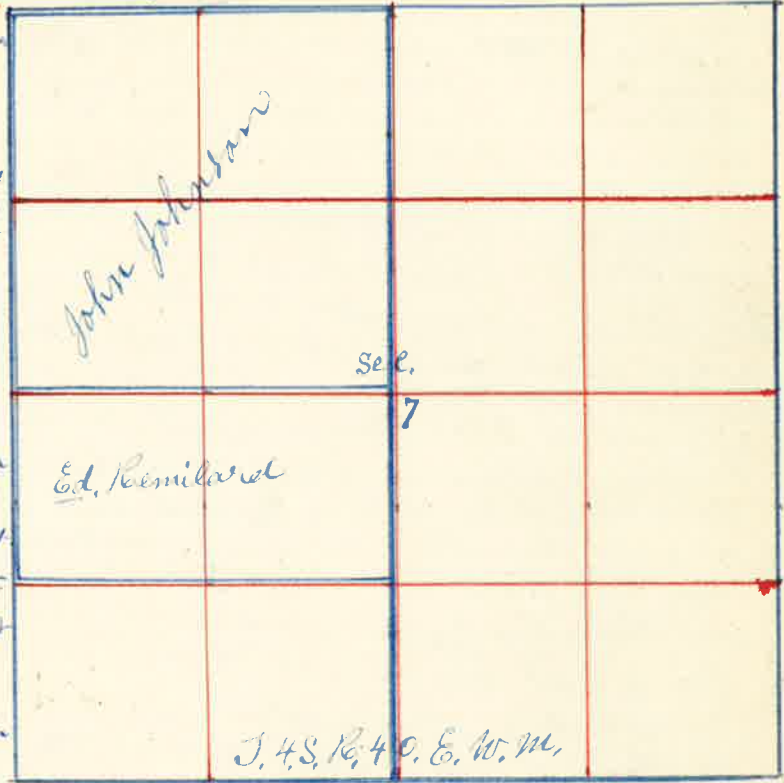

North and at 2007 chains set stone for 1/2 cor and at 4014 set stone marked 1/4 on west face for 1/4 sec cor between Sec 7 & 12, and at 8028 chains set stone for cor to Sec 1-12-6 & 7 thence North at 4014 chains set stone for 1/4 sec cor between Sec 1 & 6 and at 8028 chains the cor to Sec 1-6-31 & 36 the corner to Sec 12-13-7-12 thence East at 3980 chains set stake for temporary 1/4 sec cor at 7980 chains set support cor to Sec 7-8-12 & 13 thence East at 3993 chains set stake for temporary 1/4 sec cor and at 7989 chains the corner to Sec 8-9-16 & 17 the from which I run West and at 3993 chains a stone marked 1/4 at 7987 the cor to Sec 7-8-12-13 and thence West at 4001 chains set stake for 1/4 sec cor between Sec 7 & 12. the corner to Sec 7-8-12 & 13 thence North at 40 chains set stake for 1/4 sec cor at 80 chains set stake for temporary corner to Sec 5-6-7 & 8. Thence North at 8044 chains the N.E. corner Sec 6 making an excess of 60 links in 2 miles from which I run South and at 8060 chains set stone for cor to Sec 5-6-7 & 8 and at 4015 chains further on set stone for 1/4 sec cor between Sec 7 & 8. 8030 sec cor I then started at cor to Sec 4-5-8 & 9 thence West at 8047 chains a stone at thence West at 40 chains set post at 8075 the N.W. cor Sec 7 from which I run East at 4004 chains set stone for 1/4 sec cor between Sec 6 & 7 thence South at 4011 chains the center Sec 7 at 8022 chains 1/4 sec cor on West side Sec 7 thence North 2006 chains set stake for 1/4 cor. The 1/4 sec cor on West side Sec 7 thence East at 3989 chains the center Sec 7.

J.W. Kimbrell Dept. Co Surveyor

Surveyed for Parcel Titus Haynes & Lee May 1st 1885

By J.W. Kimbrell Dept. Co. Surveyor Plat No. 33

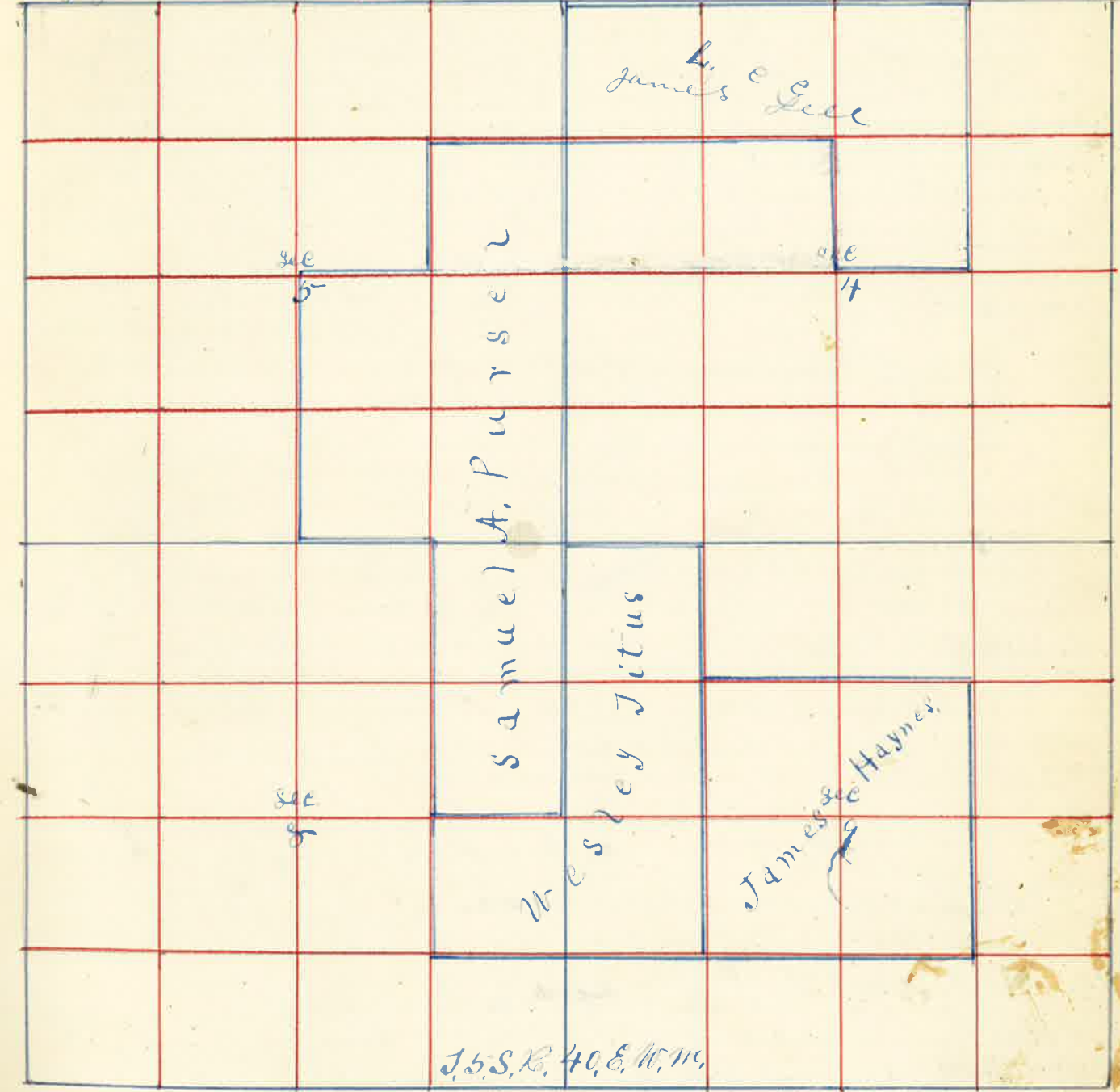

I started at the corner to Sec 4-5-8 & 9 thence I run East 20 chains set post for temporary 1/2 cor. 3986 chains 1/4 sec cor from top of Sec 4 thence West 1993 chains set post in ground of stone. the 1/4 sec cor on North side Sec 9 thence East at 20 chains set stake at 4010 chains the N.E. cor Sec 9 from which I run West at 2005 chains set post for 1/2 cor. Thence South 20 chains set post 4015 chains 1/4 sec cor on East side Sec 9 from which I run North 2007 chains set post for 1/2 cor. the 1/4 sec cor on East side Sec 9 thence South 20 chains set post 4014 chains S.E. corner Sec 9 from which I run North 2007 chains set post for 1/2 cor. the S.E. corner thence West 20 chains set post 4012 chains 1/4 sec cor on South side Sec 9 from which I run East 2006 chains set post for 1/2 cor.