

117-168
 125-522
 132-350

I O W C Nelson County Surveyor of Baker County Oregon
 hereby certify that a part of Block 22 shown on after
 description was vacated June 5th 1937 and recorded
 in Book 27736 at page 255.
 Beginning at the SE corner of Block 11 of Millvale Addition
 to the city of Baker Ore which point is on the W. line
 of Clark St where it intersects with the N. line of
 Indiana Ave thence N on east 7/8 line of Clark St
 55 W. more or less to the East met corner of Block 1
 which is part of the 7 boundaries of Millvale Addition
 thence westerly on above described center line 70 feet
 to the E line of Clark St; thence southerly, with E line
 of Clark St 55 feet to the 7 line of Indiana Ave thence
 southerly on above described center line 70 feet
 the point of beginning.

D.W.C. Nelson
 County Surveyor

Vacated June 5th 1937
 Book 27736 Page 255

WILDOVALE

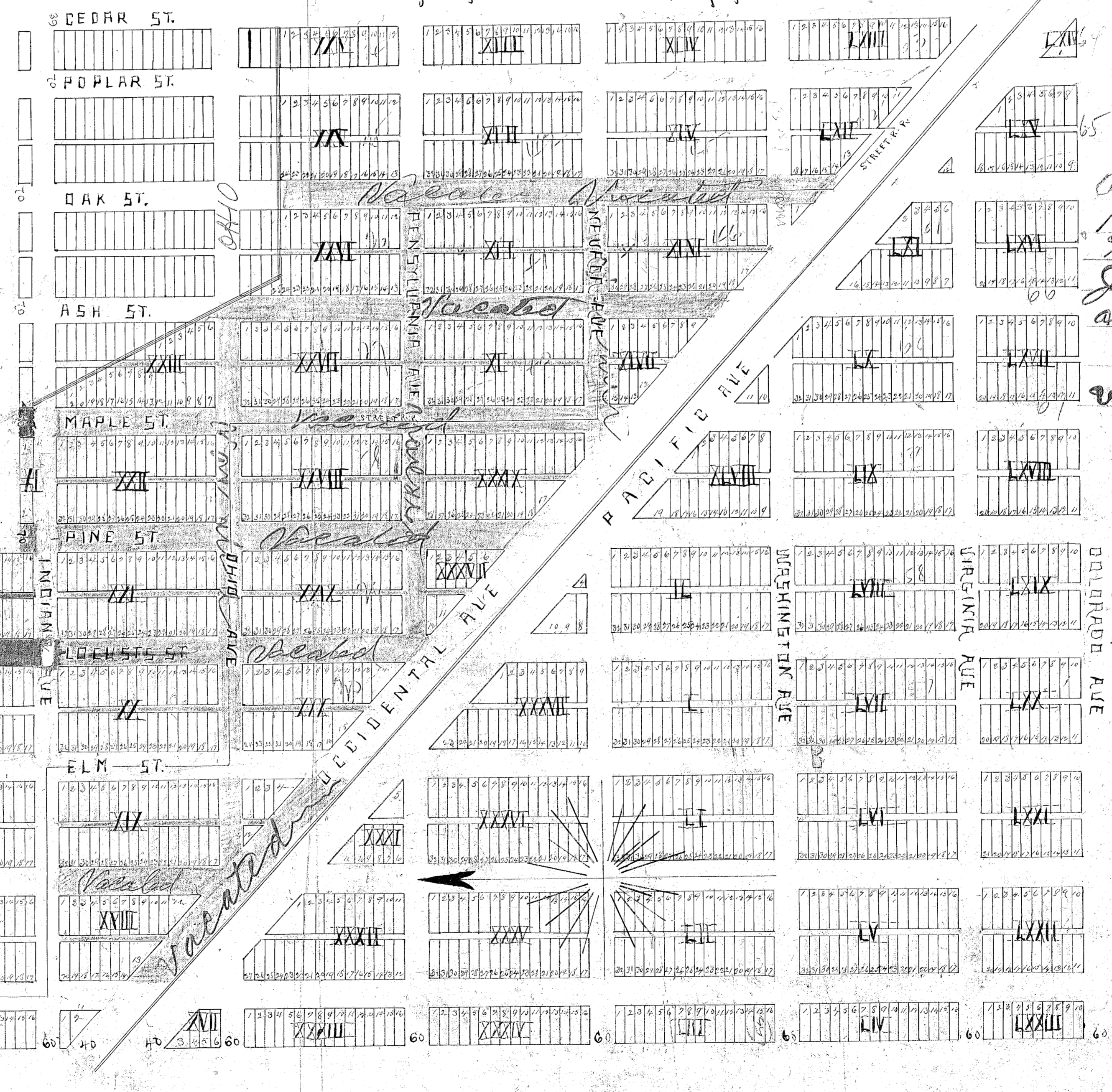
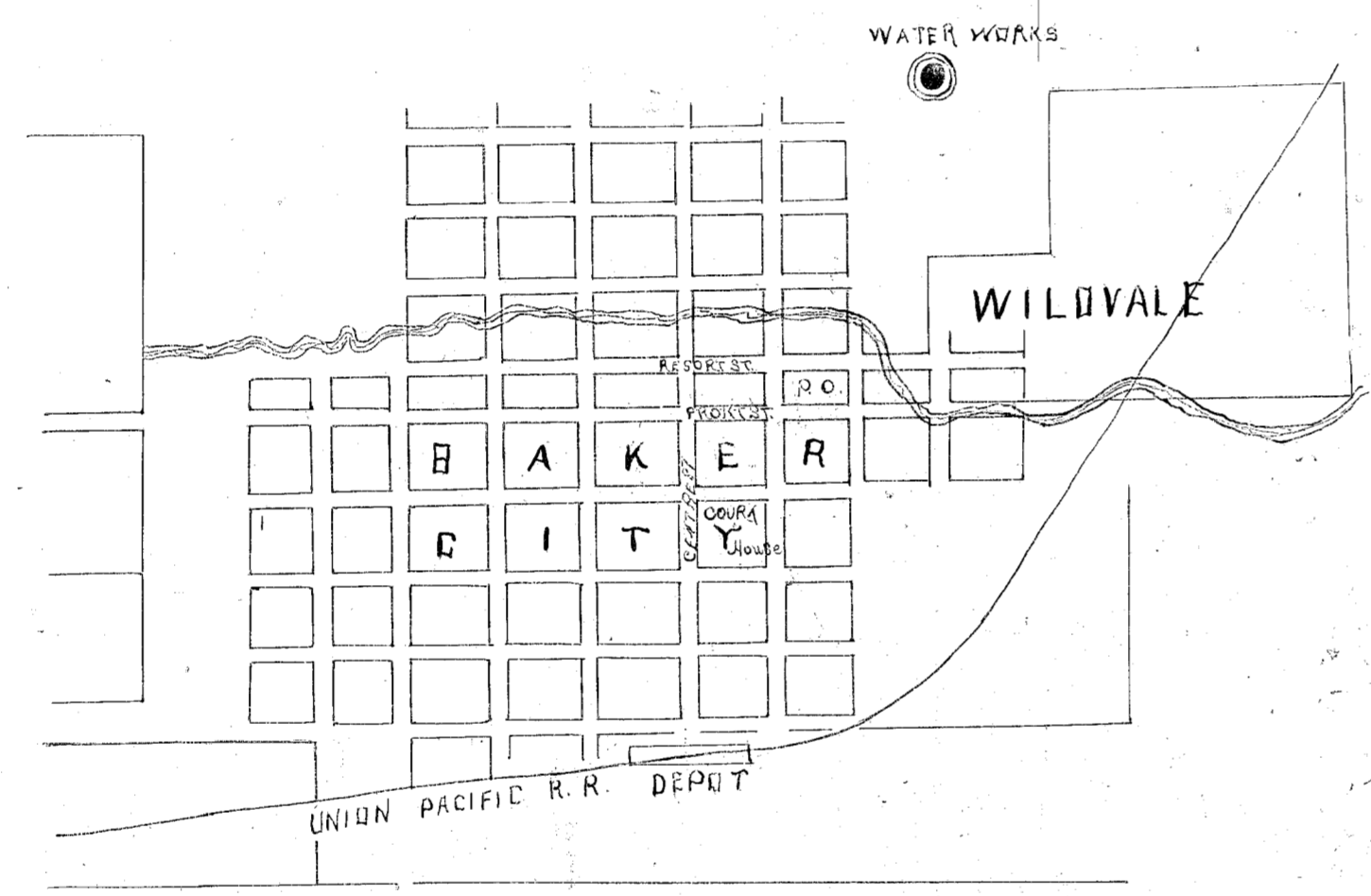

Ordinance 2126 recorded in Book 27736 at page 124
 1937 Vacating all streets & alleys
 marked in Red by me this 28th day
 July 1937 of the Plat of Millvale
 addition to Baker in Baker County Oregon

D.W.C. Nelson
 County Surveyor
 for Baker County Oregon

Ordinance 2127 Book 125 Page 252 Decided
 in Millvale Addition
 Grove Street bounded on North by South Line
 MYNLE STREET on South by North Line Cliff St
 THAT PORTION OF GROVE STREET on NORTH
 by South Line Cliff St. on SOUTH N. Line
 INDIANA & Aileys RUNNING N & S. THROUGH
 BLOCKS 10 and 12.

D.W.C. Nelson
 County Surveyor