

Set Initial Point at corner referenced by BT and BT stump.

- LEGEND
- Found BLM brass cap.
 - Found M.S. No. 867 corner or accessories.
 - Set 3/8" rebar.

ROAD CENTERLINE CURVE AND TANGENT DATA

N. 29°13'50"W,	① N. 48°59'40"W,	② N. 01°27'35"W,	③ N. 42°10'35"W,	④ N. 55°57'35"W,
18° C.L.	26° C.R.	18° C.L.	10° C.L.	10° C.L.
Δ 19°45'50"	Δ 47°32'05"	Δ 40°43'00"	Δ 13°41'00"	Δ 13°41'00"
T 55.45'	T 97.05'	T 118.12'	T 69.25'	T 69.25'
L 109.80'	L 182.03'	L 226.20'	L 137.83'	L 137.83'
N. 10°53'45"W,	⑤ N. 34°54'15"E,	⑥ S. 60°53'20"E,	⑦ N. 77°04'05"E,	
18° C.R.	26° C.R.	16° C.L.	16° C.L.	
Δ 45°48'00"	Δ 84°12'25"	Δ 42°02'35"		
T 134.46'	T 199.14'	T 137.62'		
L 254.45'	L 323.88'	L 262.77'		

SURVEYOR'S STATEMENT

I, James D. Hanley, being first duly sworn, say that I have correctly surveyed and plotted the land represented by the accompanying plat of SPARTA RECREATION LANDS, the exterior boundary of which encompasses Mineral Survey No. 867 known as the Pathfinder Group, excepting the New York lode therefrom, and further described as follows: Beginning at the Initial Point of this survey marked by a galvanized iron pipe, two inches in diameter, thirty-six inches long, and set six inches below the ground surface, at a point which is S. 78°16'35"E., 1772.04 feet from the corner common to Sections 24 and 25, T. 7S., R. 43E., W.M. and to Sections 19 and 30, T. 7S., R. 44E., W.M., said point also being Cor. No. 3 of the Mohican lode of the said Mineral Survey No. 867; thence S. 31°33'10"W., 599.69 feet to Cor. No. 4 of the Mohican lode; thence N. 59°08'15"W., 1495.14 feet to Cor. No. 1 of the Mohican lode, identical with Cor. No. 1 of the Eclipse lode; thence N. 57°53'35"W., 1503.59 feet to Cor. No. 2 of the Eclipse lode, identical with Cor. No. 1 of the Sovereign lode; thence N. 58°36'55"W., 1505.75 feet to Cor. No. 2 of the Eclipse lode; thence N. 31°40'10"E., 1199.08 feet to Cor. No. 4 of the Coin lode; thence S. 58°50'25"E., 1499.84 feet to Cor. No. 1 of the Coin lode, identical with Cor. No. 4 of the Goodyear lode and Cor. No. 3 of the London lode; thence N. 31°02'25"E., 602.96 feet to Cor. No. 4 of the London lode, identical with Cor. No. 3 of the Foster lode and Cor. No. 2 of the New York lode; thence N. 32°11'15"E., 592.91 feet to Cor. No. 1 of the New York lode, identical with Cor. No. 4 of the Foster lode; thence S. 58°41'55"E., 1491.34 feet to Cor. No. 1 of the Foster lode; thence S. 31°38'50"W., 600.57 feet to Cor. No. 2 of the Foster lode, identical with Cor. No. 1 of the London lode; thence S. 30°00'50"W., 605.89 feet to Cor. No. 2 of the London lode, identical with Cor. No. 1 of the Goodyear lode; thence S. 31°32'05"W., 600.27 feet to Cor. No. 2 of the Goodyear lode, identical with Cor. No. 4 of the Sovereign lode and Cor. No. 3 of the Eclipse lode; thence S. 58°30'50"E., 1500.52 feet to Cor. No. 4 of the Eclipse lode, identical with Cor. No. 2 of the Mohican lode; thence S. 58°30'30"E., 1500.40 feet to Cor. No. 3 of the Mohican lode and the point of beginning.

I, James G. Voelz, County Surveyor for Union County, Oregon certify that I have examined the plat of Sparta Recreation lands subdivision and that it complies with the statutes of this state and is therefore approved.



Subscribed and sworn before me this 28 day of April, 1978.

Becky L. Gray Notary Public for Oregon.
My commission expires 4-3-1981

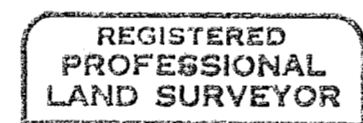

JAMES D. HANLEY
OREGON
SEPTEMBER 23, 1977
JAMES D. HANLEY
1206

James G. Voelz
Dec. 9, 1977

All taxes and assessments are paid to June 30, 1978

Ralph L. McPray
County Assessor

KNOW ALL MEN BY THESE PRESENTS: That Alvin C. Ward, Lois A. Ward, Ralph E. Ward and Alice L. Ward, the owners and claimants of the tract herein described, do hereby declare and acknowledge that the accompanying annexed map is the authorized plat of SPARTA RECREATION LANDS subdivision.

Alvin C. Ward
Lois A. Ward
Ralph E. Ward
Alice L. Ward

STATE OF OREGON
COUNTY OF BAKER
BE IT REMEMBERED, that on May 1, 1978, before me did personally appear the within named Alvin C. Ward, Lois A. Ward, Ralph E. Ward and Alice L. Ward and acknowledged to me that they executed the same freely and voluntarily.

Carylene L. Morris
Notary Public for Oregon
My commission expires July 13, 1981

We, the undersigned officers in and for Baker County, Oregon do hereby approve the plat of SPARTA RECREATION LANDS.

Wm. W. Quigley 5/1/78
Planning Director
Armond A. Fuller 5/16/78
County Judge
George V. McCalister
County Commissioner
Fred W. (Dinger)
County Commissioner

