

We, the undersigned officers in and for Baker County, Oregon do hereby approve the plat of

James D. Hanley 4/14/80 County Judge
Date
Fred W. Briggs 4/17/80 Co. Commissioner
Date
Stewart Sullivan Co. Commissioner
William L. ... 4/17/80 Planning Commission Director
Date

We, Ralph L. McCray and Alice L. Saunders, duly elected, acting and qualified Assessor and Tax Collector, respectively, of Baker County, Oregon hereby certify that all ad-valorem taxes and other special assessments due thereon pursuant to ORS 92.035, have been paid, and hereby approve said plat.

Ralph L. McCray 4-14-80
Alice L. Saunders 4-14-80

I, James Voelz, County Surveyor for Union County, Oregon certify that I have examined the plat of ORR SUBDIVISION, and that it complies with the statutes of this state and is therefore approved.

James Voelz 3/24/80
Date

KNOW ALL MEN BY THESE PRESENTS That, the undersigned owner and claimant of the parcel herein described, does hereby declare and acknowledge the accompanying to be the authorized plat of ORR SUBDIVISION and hereby dedicates to the use of the public, that part of the road shown on the accompanying plat owned by the undersigned.

Ted W. Orr
Virginia E. Orr

STATE OF OREGON } S.S.
COUNTY OF BAKER }
BE IT REMEMBERED That on this 26th day of June, 1980, before me, a Notary Public in and for said county and state, personally appeared Ted Orr and Virginia E. Orr, who after being first duly sworn, did say they are the identical persons named and described in the foregoing instrument and that their signatures affixed are of their own free act and deed.

Tonya A. Conklin
NOTARY PUBLIC FOR OREGON

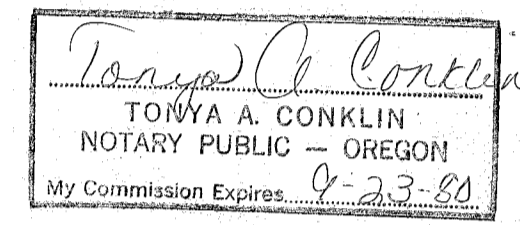

SURVEYOR'S STATEMENT

I, James D. Hanley, being first duly sworn, say that I have correctly surveyed, monumented, and platted the land represented on the accompanying plat of ORR SUBDIVISION, the exterior boundaries of which are described as follows: Beginning the Initial Point of this survey, marked by a 2-inch diameter iron pipe, thirty-six inches long, on the easterly right of way line of a Baker County road at a point which is 5.41° 26' 38" W., 1894.10 feet from the North quarter corner of Section 2, T. 7S., R. 39E., W.M.; thence following the county road right of way line: S. 02° 09' 07" E., 600.77 feet; thence on 174.63 foot radius curve left (the long chord of which bears S. 24° 42' 52" E., 136.55 feet) a distance of 137.54 feet; thence S. 47° 16' 47" E., 820.41 feet; thence S. 50° 19' 54" E., 1541.93 feet; thence S. 51° 30' 44" E., 1343.13 feet; thence on a 602.96 foot radius curve right (the long chord of which bears S. 43° 09' 11" E., 175.93 feet) a distance of 175.93 feet; thence S. 34° 47' 44" E., 986.60 feet; thence S. 02° 14' 07" E., 227.62 feet; thence on a 174.63 foot radius curve left (the long chord of which bears S. 34° 00' 17" E., 183.89 feet) a distance of 193.65 feet; thence S. 65° 46' 17" E., 131.85 feet; thence leaving the county road right of way line, N. 01° 29' 06" W., 385.08 feet; thence N. 32° 35' 19" W., 608.71 feet; thence N. 05° 58' 48" W., 762.12 feet; thence N. 04° 12' 27" W., 304.20 feet to the North line of the SE 1/4 SE 1/4 of Section 2; thence S. 88° 04' 40" W., 649.09 feet to the Southeast corner of the NW 1/4 SE 1/4; thence N. 02° 22' 37" W., 1326.85 feet to the Northeast corner of the NW 1/4 SE 1/4; thence S. 88° 08' 42" W., 1326.92 feet to the center of Section 2; thence N 02° 24' 19" W., 1303.48 feet along the East line of SE 1/4 NW 1/4; thence S. 87° 50' 53" W., 1312.19 feet to the point of beginning.

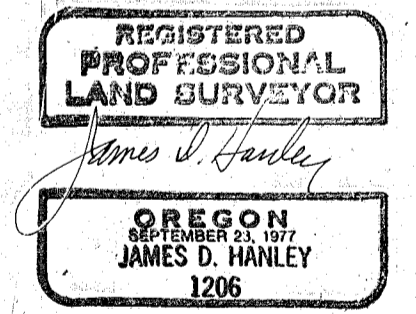

Subscribed and Sworn before me this 2nd day of April, 1980

James D. Hanley
NOTARY PUBLIC FOR OREGON

My Commission Expires 7/4/82.

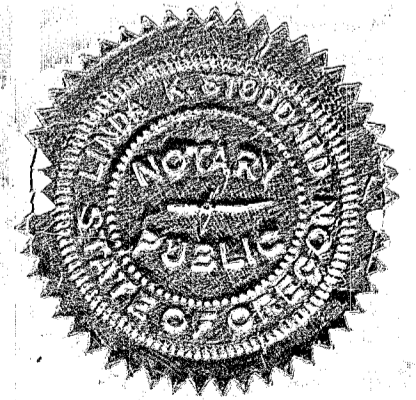

Re Recorded 13745

June 26, 1980

Antia C. Johnson
Deputy

13745

April 18, 1980

Antia C. Johnson
Deputy