

# MICHIGAN PARK ADDITION BAKER CITY.

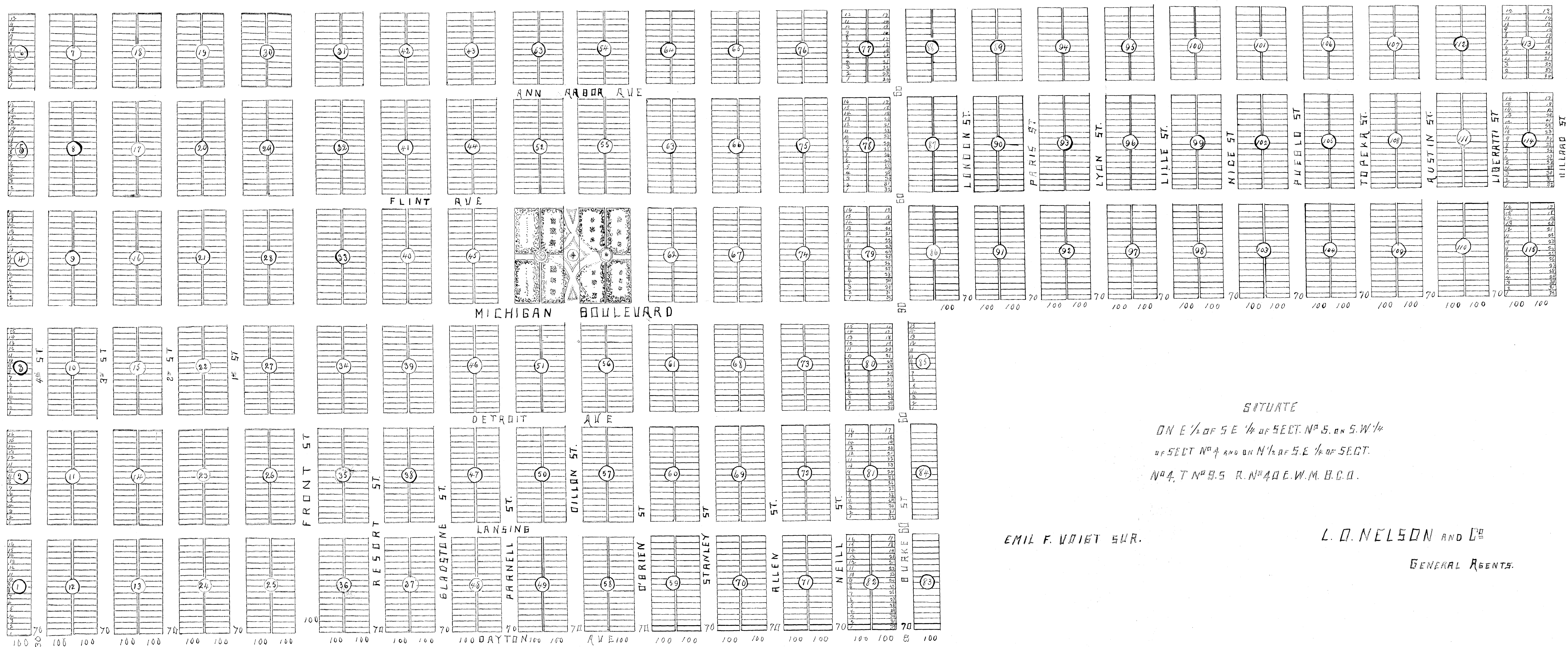

SITUATE  
 ON E 1/2 OF SE 1/4 OF SECT. N 5. ON S.W. 1/4  
 OF SECT. N 4 AND ON N 1/2 OF S.E. 1/4 OF SECT.  
 N 4, T N 9 S. R. N 40 E. W. M. B. C. O.

EMIL F. VOIET SUR.

L. O. NELSON AND CO  
 GENERAL AGENTS.