

Pehrenbach's Addition, TO BAKER CITY, OREGON.

Situated on the North East,
Quarter of the South West, quarter of Sec.
8, Tp. No. 9 South of Range No 40 E & W N.
G. B. Maggoner, C. E.

Scale of 100 ft. to 1 inch.

Filed for record May
20th 1890

E. H. Mix
Clerk
By J. W. Gray
Deputy

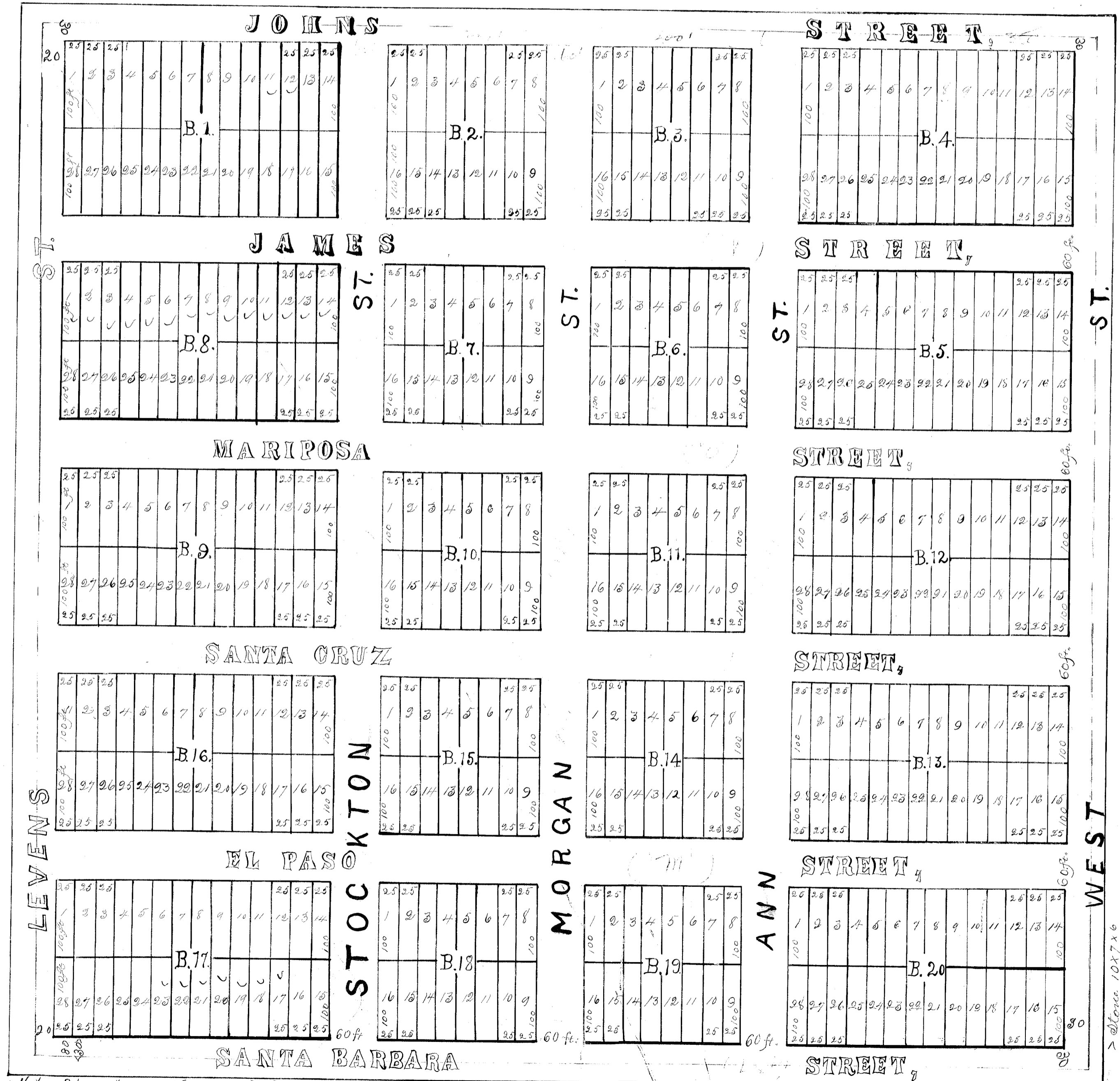

Note: Streets on North and South are 30 ft.
" " East " West " 20 ft

100 ft. 10x7x6