

Map of  
DENNY ADDITION  
to  
BAKER CITY.

Dedication

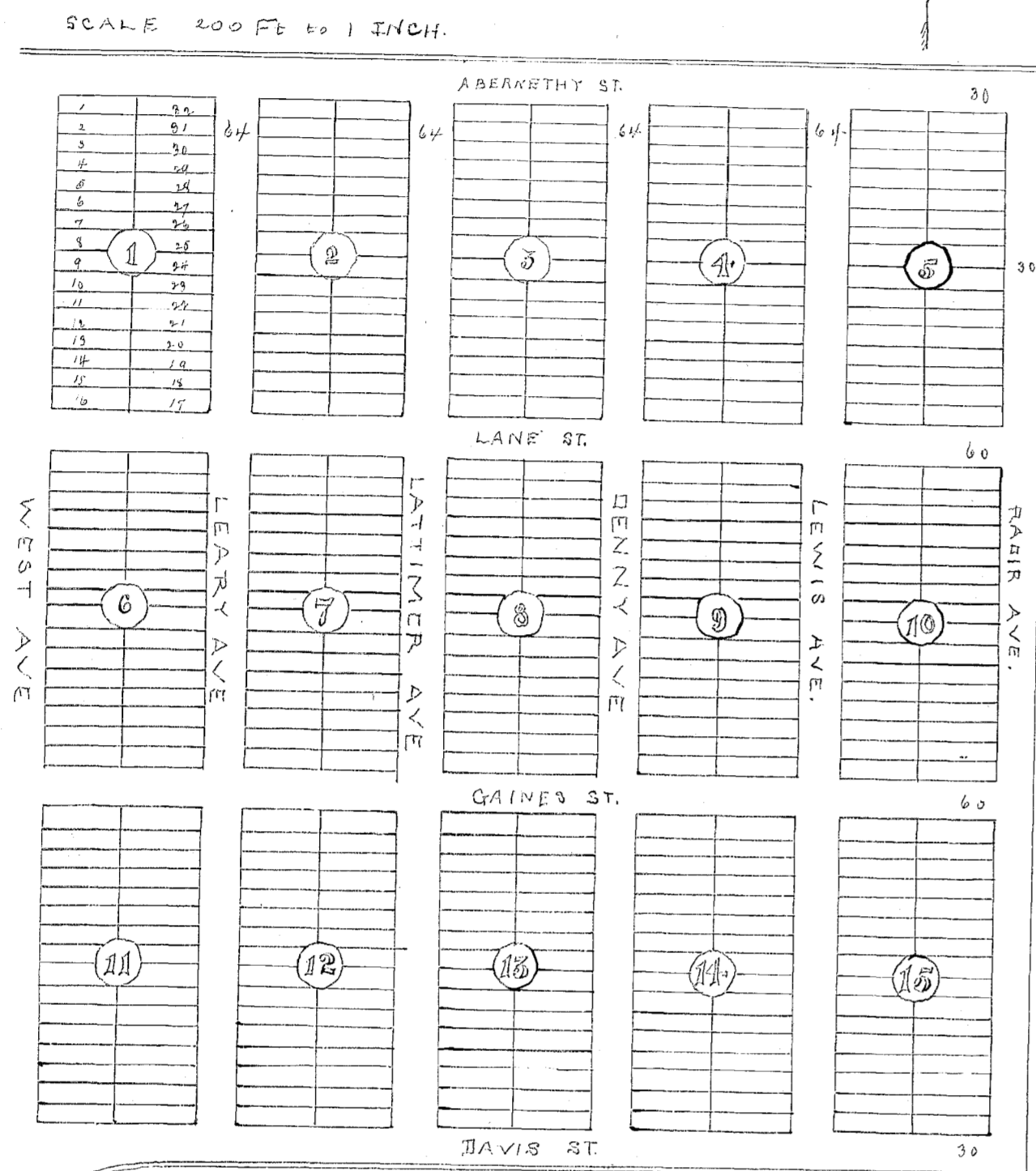

Know all men by these presents that we, A. A. Denny and his wife Mary A. Denny, do hereby make and declare this map & plat to be the map and plat of Denny Addition to Baker City, Situated in Sec. 8 in Township 9 South Range 40 East, and being more particularly described as the N.W. quarter of the S.E. quarter of said Sec 8 and we do hereby dedicate to the use of the public as roads, streets, alleys, avenues and public highways thereon, all that are designated and shown as such.

In witness whereof we have hereunto set our hands and seals this 19<sup>th</sup> day of May, 1890.

In the presence of  
M. L. Denny  
Theo. G. Haller  
State Notary  
County of King

A. A. Denny  
Mary A. Denny

This certifies that on the 19<sup>th</sup> day of May, 1890 before me the undersigned Notary Public in and for said County and State personally appeared the within named A. A. Denny and his wife Mary A. Denny who are known to me to be the identical persons described in said instrument and who executed the same freely voluntarily for the uses and purposes therein mentioned, and Mary A. Denny on an examination made by me separate and apart from her said husband acknowledged to me that she executed the same freely and voluntarily and without fear coercion or compulsion from any one.

In testimony whereof I have hereunto set my hand and Notarial Seal the day and year last above mentioned

Received for record the 21<sup>st</sup> May 1890

at 5 o'clock P.M.  
F. H. Mix.  
County Clerk  
By J. W. Lewis  
Deputy

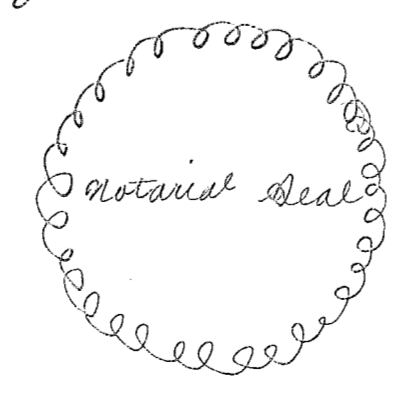

Theo. G. Haller  
Notary Public  
State of Wash.