

N.W. Cor. of  
N. 1/2 of NE 1/4  
of Sec. 8

James A. A. Wilson

Sec 5 Sec 4  
Sec. Cor. Sec. 4, 5, 8 & 9

HUNSUCKER CREEK  
Sec 8 Sec 9

ALTA VISTA MT.

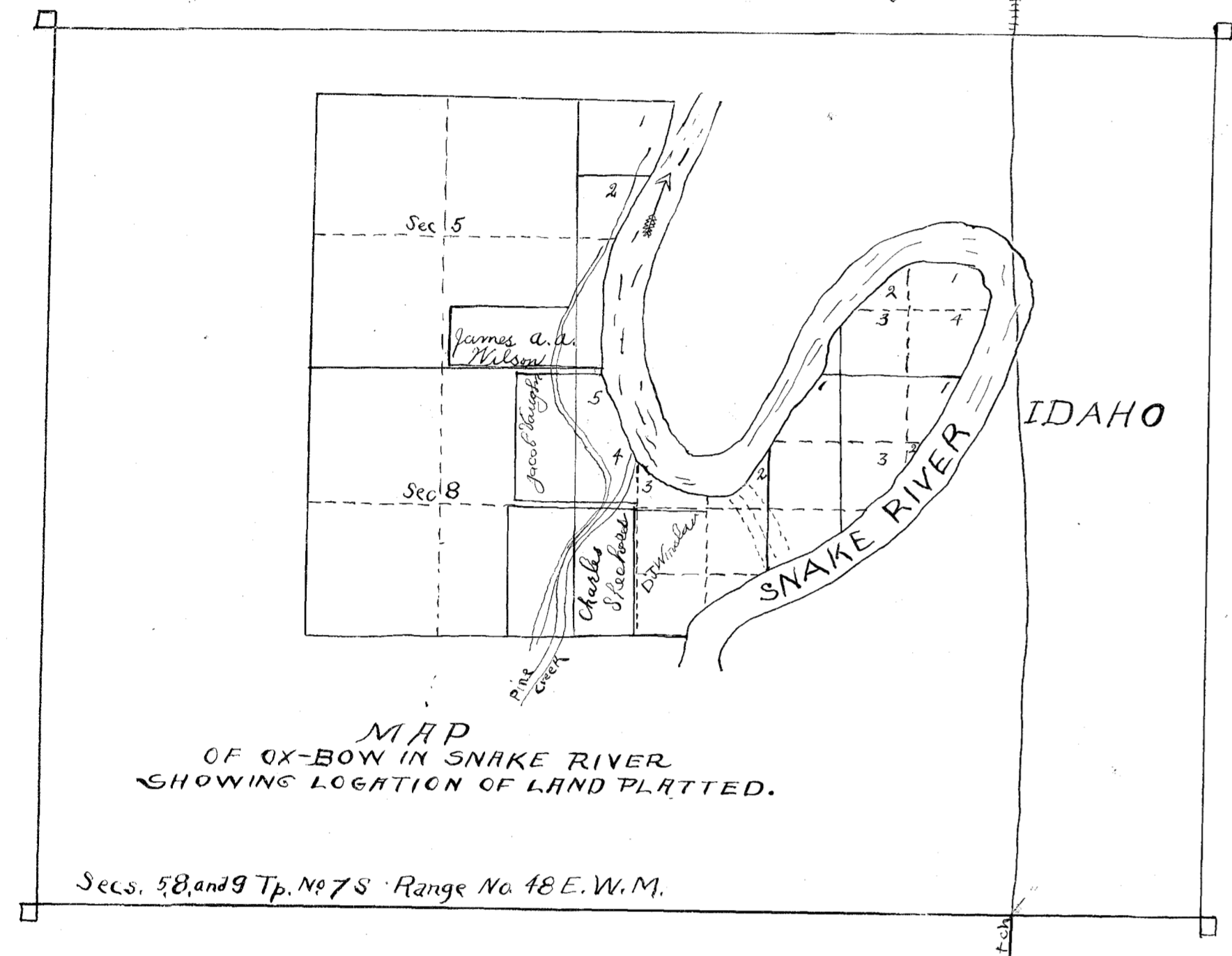

VADGEM MOUNTAIN

MAP  
OF  
Block 1 to 28  
BOTH NUMBERS INCLUSIVE OF  
COPPERFIELD  
TOWNSITE  
BAKER COUNTY ORE.  
Scale 100 feet to 1 inch  
W. B. Blakeslee Surveyor

