

PARTITION PLAT No. 2019- 06

A PARTITION OF PARCEL 4 OF PARTITION PLAT 2018-001, AND IN THE EAST ONE-HALF OF NORTHWEST ONE-QUARTER, AND IN THE WEST ONE-HALF OF NORTHEAST ONE-QUARTER OF SECTION 24, TOWNSHIP 8 SOUTH, RANGE 40 EAST, WILLAMETTE MERIDIAN, BAKER COUNTY, OREGON

SURVEYOR'S CERTIFICATE

I, RICHARD E. STEIN, OREGON REGISTERED LAND SURVEYOR NO. 49593PLS, DO HEREBY CERTIFY AND SAY THAT I HAVE CORRECTLY SHOWN THE RECORD BOUNDARIES OF THIS PARTITION PLAT, THAT I HAVE CORRECTLY SURVEYED THE BOUNDARIES OF THE LAND REPRESENTED ON THE ATTACHED PARTITION PLAT IN ACCORDANCE WITH THE PROVISIONS OF O.R.S. CHAPTER 92 AND THE COUNTY OF BAKER ORDINANCES. SAID LAND IS SITUATED IN SECTION 24, T & S, R.40 E., WILLAMETTE MERIDIAN, BAKER COUNTY, OREGON, AND MORE PARTICULARLY DESCRIBED AS FOLLOWS:
PARCEL 4 OF PARTITION PLAT NO. 2018-001, RECORDED MARCH 7, 2018 AS INSTRUMENT NO. B18100145, BAKER COUNTY RECORDS BEING THE SOUTHWEST QUARTER OF THE NORTHWEST QUARTER, THE SOUTHWEST QUARTER, AND THE EAST HALF OF THE SOUTHWEST QUARTER OF SECTION 24, TOWNSHIP 8 SOUTH, RANGE 40 EAST, WILLAMETTE MERIDIAN, BAKER COUNTY, OREGON. CONTAINING 280 ACRES OF LAND, MORE OR LESS.

TOGETHER WITH:
THE SOUTHWEST QUARTER OF THE NORTHEAST QUARTER, THE SOUTHWEST QUARTER OF THE NORTHWEST QUARTER, THE NORTHEAST QUARTER OF THE NORTHWEST QUARTER, AND THE NORTHWEST QUARTER OF THE NORTHWEST QUARTER OF SECTION 24, TOWNSHIP 8 SOUTH, RANGE 40 EAST, WILLAMETTE MERIDIAN, BAKER COUNTY, OREGON EXCEPTING THEREFROM: THE FOLLOWING THREE PARCELS:
PARCEL NO. 1: A PARCEL IN THE NORTHWEST QUARTER OF THE NORTHEAST QUARTER OF SECTION 24, TOWNSHIP 8 SOUTH, RANGE 40 EAST, WILLAMETTE MERIDIAN, BAKER COUNTY, OREGON, MORE PARTICULARLY DESCRIBED AS FOLLOWS:
BEGINNING AT A POINT WHICH IS THE EAST SIXTEENTH CORNER COMMON TO SECTIONS 13 AND 24, SAID TOWNSHIP AND RANGE. SAID POINT BEARS 587°54'51"W, 1339.81 FEET FROM THE NORTHEAST CORNER OF SAID SECTION 24; THENCE 501°49'08"E, 367.93 FEET; THENCE 587°54'39"W, 400.01 FEET; THENCE N01°49'07"W, 338.12 FEET TO THE SOUTHERLY RIGHT OF WAY OF HIGHWAY 203; THENCE 176.52 FEET ON A SPIRAL CURVE TO THE LEFT, THE LONG CHORD OF WHICH BEARS N78°09'27"E, 176.02 FEET TO THE NORTHERLY LINE OF SAID SECTION 24; THENCE N87°54'51"E ALONG SAID NORTHERLY LINE, 226.74 FEET TO THE POINT OF BEGINNING.

PARCEL NO. 2: HIGHWAY RIGHT OF WAY CONVEYED TO THE STATE OF OREGON, BY AND THROUGH ITS STATE HIGHWAY COMMISSION, BY INSTRUMENT RECORDED OCTOBER 2, 1948, IN BOOK 148, PAGE 439, BAKER COUNTY DEED RECORDS.

PARCEL NO. 3: HIGHWAY RIGHT OF WAY CONVEYED TO THE STATE OF OREGON, BY AND THROUGH ITS STATE HIGHWAY COMMISSION, BY INSTRUMENT RECORDED DECEMBER 2, 1948, IN BOOK 149, PAGE 202, BAKER COUNTY DEED RECORDS.

CONTAINING 442.563 ACRES OF LAND, MORE OR LESS.

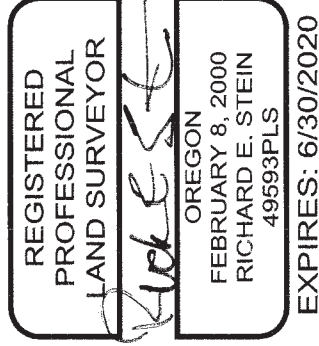

DECLARATION

KNOW ALL PERSONS BY THESE PRESENTS THAT BERT SIDDOWNAY AND TERRI SIDDOWNAY, AS TENANTS BY THE ENTIRETY, THE OWNERS OF THE LANDS REPRESENTED ON THIS LAND PARTITION AND MORE PARTICULARLY DESCRIBED IN THE SURVEYOR'S CERTIFICATE HAVE CAUSED SAID LANDS TO BE PARTITIONED IN ACCORDANCE WITH O.R.S. CHAPTER 92.

Bert Siddoway
BERT SIDDOWNAY

Terri Siddoway
TERRI SIDDOWNAY

ACKNOWLEDGEMENTS

STATE OF OREGON (55)
COUNTY OF BAKER

KNOW ALL PEOPLE BY THESE PRESENTS, ON THIS 30th DAY OF September, 2019, BEFORE ME, A NOTARY PUBLIC IN AND FOR SAID STATE AND COUNTY, PERSONALLY APPEARED AND BERT SIDDOWNAY AND TERRI SIDDOWNAY, AS INDIVIDUALS AND ACKNOWLEDGED THE FOREGOING TO BE THEIR VOLUNTARY ACT AND DEED.

Stefanie Kirby
NOTARY PUBLIC OF THE STATE OF OREGON
987492
NOTARY NUMBER
May 23, 2023
MY COMMISSION EXPIRES

APPROVALS

BAKER COUNTY SURVEYOR

EXAMINED AND RECOMMENDED FOR APPROVAL AS PER O.R.S. CHAPTER 92

THIS 24th DAY OF Sept., 2019

Tom Hanley
TOM HANLEY, BAKER COUNTY SURVEYOR

BAKER COUNTY PLANNING DEPARTMENT

EXAMINED AND APPROVED

THIS 30th DAY OF September, 2019

Haley Brown
BAKER COUNTY PLANNING DIRECTOR

BAKER COUNTY TREASURER

I HEREBY CERTIFY THAT PURSUANT TO O.R.S. 92.095, ALL AD VALOREM TAXES AND ALL SPECIAL ASSESSMENTS, FEES AND OTHER CHARGES REQUIRED BY LAW TO BE PLACED UPON THE 2019-2020 TAX ROLL WHICH BECAME A LIEN ON THE LAND WITHIN THIS PARTITION, OR WILL BECOME A LIEN DURING THE TAX YEAR BUT NOT CERTIFIED TO THE TAX COLLECTOR FOR COLLECTION HAVE BEEN PAID.

APPROVED THIS 30th DAY OF September, 2019

Nice Phillips
BAKER COUNTY TREASURER

FILING STATEMENT

STATE OF OREGON (55)
COUNTY OF BAKER

I DO HEREBY CERTIFY THAT THE ATTACHED PARTITION PLAT WAS PRESENTED FOR RECORDING ON

THE 30 DAY OF September 2019, AT 10:00 O'CLOCK A.M., AND RECORDED AS PARTITION PLAT

NO. 2019-06 IN PLAT CABINET NO. D SLIDE NO. 33 BAKER

COUNTY RECORDS. INSTRUMENT NUMBER B1939 0059

Stefanie Kirby
BAKER COUNTY CLERK

BY: *Karen Phillips*, Deputy

**PARTITION PLAT -
LOCATED IN SEC. 24, T.8S., R.40E., W.M.
BAKER COUNTY, OR.**

SCALE: NONE
DATE: 09/24/2019
JOB NO. 781-57 (211)



ANDERSON PERRY & ASSOCIATES, INC.
1901 N. FIR STREET
LA GRANDE, OREGON 97850
1-541-963-6309

P.O. BOX 115
DURKEE, OR 97905