

SURVEYOR'S CERTIFICATE

B14 09 0198

B14 09 0200

I, TIMOTHY P. ROUSE, A PROFESSIONAL REGISTERED LAND SURVEYOR IN THE STATE OF OREGON, DO HEREBY CERTIFY THAT I HAVE CORRECTLY SURVEYED AND MARKED ON THE GROUND WITH PROPER MONUMENTATION THE LAND REPRESENTED ON THIS REPLAT IN ACCORDANCE WITH O.R.S. CHAPTER 92. SAID REPLAT IS LOCATED IN THE SOUTHWEST 1/4 OF SECTION 30, TOWNSHIP 11 SOUTH, RANGE 40 EAST, WILLAMETTE MERIDIAN, IN BAKER COUNTY, OREGON, MORE PARTICULARLY DESCRIBED AS FOLLOWS:

PARCEL 1: COMMENCING AT CORNER #2 OF THE "SOUTH PLACER MINERAL SURVEY NO. 705" AS DESCRIBED IN PATENT RECORDED JULY 24, 1911, IN BOOK 75, PAGE 270 DEEDS AND AS RE-MONUMENTED AND RECORDED IN BAKER COUNTY SURVEY RECORDS AS NO. 11-40-78 FILED JANUARY 23, 1987, SAID POINT BEING A 2-1/2" X 30" ALUMINUM PIPE WITH 2-1/2" ALUMMINUM CAP; THENCE ALONG THE SOUTH LINE OF SAID MINERAL SURVEY NO. 705, N89°38'45"W 52.00ft. TO A 5/8" X 30" REBAR WITH A 2" ALUMINUM CAP STAMPED "ROUSE PLS 2799" TO THE TRUE POINT OF BEGINNING FOR THIS PARCEL; THENCE CONTINUING ALONG SAID SOUTH LINE, N89°38'45"W 768.81ft. TO CORNER #1 OF SAID MINERAL SURVEY NO. 705, SAID POINT BEING A 2-1/2" X 30" ALUMINUM PIPE WITH 2-1/2" ALUMMINUM CAP; THENCE NORTH ALONG THE WEST LINE OF SAID MINERAL SURVEY NO. 705, N00°21'04"E 660.73ft. TO CORNER #4, ALSO BEING CORNER #4 OF THE KLONDIKE PLACER MINERAL SURVEY NO. 611, SAID POINT BEING A 2-1/2" X 30" ALUMINUM PIPE WITH 2-1/2" ALUMMINUM CAP; THENCE EAST ALONG THE NORTH LINE OF SAID MINERAL SURVEY NO. 705, S89°39'35"E 825.14ft. TO CORNER #3, ALSO BEING CORNER #5 OF THE KLONDIKE PLACER MINERAL SURVEY NO. 611, SAID POINT BEING A 2-1/2" X 30" ALUMINUM PIPE WITH 2-1/2" ALUMMINUM CAP; THENCE LEAVING SAID NORTH LINE, S88°32'07"E, 330.55ft. TO A 5/8" X 30" REBAR WITH A 2" ALUMINUM CAP STAMPED "ROUSE PLS 2799"; THENCE S00°41'42"W 491.55ft. TO A 5/8" X 30" REBAR WITH A 2" ALUMINUM CAP STAMPED "ROUSE PLS 2799"; THENCE N88°46'33"W 382.80ft. TO A 5/8" X 30" REBAR WITH A 2" ALUMINUM CAP STAMPED "ROUSE PLS 2799"; THENCE S00°43'34"W 168.79ft. TO THE POINT OF BEGINNING OF THIS DESCRIPTION; CONTAINING 16.02 ACRES MORE OR LESS. ELECTRICAL POWER AND OTHER UTILITES ARE NOT AVAILABLE TO THE PROPERTY LINE OF PARCEL 1. EXCEPTING ANY PRIVATE OR PUBLIC EASEMENTS OR RESERVATIONS AS SAME MAY EXIST OR APPEAR OF RECORD.

PARCEL 4: COMMENCING AT CORNER #2 OF THE "SOUTH PLACER MINERAL SURVEY NO. 705" AS DESCRIBED IN PATENT RECORDED JULY 24, 1911, IN BOOK 75, PAGE 270 DEEDS AND RE-MONUMENTED AND RECORDED IN BAKER COUNTY SURVEY RECORDS AS NO. 11-40-78 FILED JANUARY 23, 1987, SAID POINT BEING A 2-1/2" X 30" ALUMINUM PIPE WITH 2-1/2" ALUMMINUM CAP; THENCE N00°43'34"E 660.94ft. TO A 2-1/2" X 30" ALUMINUM PIPE WITH 2-1/2" ALUMMINUM CAP, SAID POINT BEING CORNER #3 OF SAID MINERAL SURVEY NO. 705 AND THE TRUE POINT OF BEGINNING OF THIS DESCRIPTION; THENCE N01°10'03"E 414.07ft. TO A 5/8" X 30" REBAR WITH A 2" ALUMINUM CAP STAMPED "ROUSE PLS 2799"; THENCE S89°30'47"E 992.86ft. TO A 5/8" IRON PIN WITH A 1-1/2" YELLOW PLASTIC CAP STAMPED "HANLEY ENGR."; THENCE S00°27'31"W 429.60ft. TO A 2-1/2" X 30" ALUMINUM PIPE WITH A 2-1/2" ALUMINUM CAP; THENCE S89°22'15"E 327.20ft. TO A 2-1/2" X 30" ALUMINUM CAP ON A FLANGED 1-1/2" GALVANIZED IRON PIPE, SAID POINT BEING THE CENTER SOUTH 1/16TH CORNER OF SECTION 30; THENCE S00°13'05"W 220.88ft. UPON THE SAID CENTER OF SECTION 30, TO A 5/8" X 30" REBAR WITH A 2" ALUMINUM CAP STAMPED "ROUSE PLS 2799"; THENCE N88°31'56"W 696.09ft. LEAVING SAID CENTER OF SECTION LINE, TO A 5/8" X 30" REBAR WITH A 2" ALUMINUM CAP STAMPED "ROUSE PLS 2799"; THENCE N00°41'42"E 214.57ft. TO A 5/8" X 30" WITH A 2" ALUMINUM CAP STAMPED "ROUSE PLS 2799"; THENCE N88°32'07"W 631.12ft. TO CORNER #3 OF SAID MINERAL SURVEY NO. 705 AND THE TRUE POINT OF BEGINNING OF THIS DESCRIPTION; CONTAINING 13.11 ACRES MORE OR LESS. ELECTRICAL POWER AND OTHER UTILITIES ARE NOT AVAILABLE TO THE PROPERTY LINE OF PARCEL 4. EXCEPTING ANY PRIVATE OR PUBLIC EASEMENTS OR RESERVATIONS AS SAME MAY APPEAR OF RECORD.

PARCEL 5: COMMENCING AT CORNER #2 OF THE "SOUTH PLACER MINERAL SURVEY NO. 705" AS DESCRIBED IN PATENT RECORDED JULY 24, 1911, IN BOOK 75, PAGE 270 DEEDS AND AS RE-MONUMENTED AND RECORDED IN BAKER COUNTY SURVEY RECORDS AS NO. 11-40-78 FILED JANUARY 23, 1987, SAID POINT BEING A 2-1/2" X 30" ALUMINUM PIPE WITH 2-1/2" ALUMMINUM CAP; THENCE ALONG THE SOUTH LINE OF SAID MINERAL SURVEY NO. 705, N89°38'45"W 52.00ft. TO A 5/8" X 30" REBAR WITH A 2" ALUMINUM CAP STAMPED "ROUSE PLS 2799" TO THE TRUE POINT OF BEGINNING FOR THIS PARCEL; THENCE N00°43'34"E 168.79ft. TO A 5/8" X 30" REBAR WITH A 2" ALUMINUM CAP STAMPED "ROUSE PLS 2799"; THENCE S88°46'33"E 382.80ft. TO A 5/8" X 30" REBAR WITH A 2" ALUMINUM CAP STAMPED "ROUSE PLS 2799"; THENCE N00°41'42"E 491.55ft. TO A 5/8" X 30" REBAR WITH A 2" ALUMINUM CAP STAMPED "ROUSE PLS 2799"; THENCE S88°32'07"E 300.57ft. TO A 5/8" X 30" REBAR WITH A 2" ALUMINUM CAP STAMPED "ROUSE PLS 2799"; THENCE S00°41'42"W 214.57ft. TO A 5/8" X 30" REBAR WITH A 2" ALUMINUM CAP STAMPED "ROUSE PLS 2799"; THENCE S88°31'56"E 696.09ft. TO A 5/8" X 30" REBAR WITH A 2" ALUMINUM CAP STAMPED "ROUSE PLS 2799", SAID POINT BEING ON THE CENTER LINE OF SECTION 30; THENCE S00°13'05"W 440.27ft. UPON THE CENTER LINE OF SECTION 30, TO A 5/8" X 30" REBAR WITH A 2" ALUMINUM CAP STAMPED "ROUSE PLS 2799"; THENCE N88°49'51"W 1383.16ft. LEAVING SAID CENTER OF SECTION LINE TO THE TRUE POINT OF BEGINNING OF THIS DESCRIPTION. CONTAINING 13.10 ACRES MORE OR LESS. POWER AND OTHER UTILITIES ARE NOT AVAILABLE TO THE PROPERTY LINE OF PARCEL 5. EXCEPTING ANY PRIVATE OR PUBLIC EASEMENTS OR RESERVATIONS AS SAME MAY APPEAR OF RECORD.

REPLAT NO. P2014-003

A REPLAT OF LAND LOCATED IN THE SOUTHWEST QUARTER OF SECTION 30, TOWNSHIP 11 SOUTH, RANGE 40 EAST, WILLAMETTE MERIDIAN IN BAKER COUNTY, OREGON

DECLARATION

KNOW ALL PEOPLE BY THESE PRESENTS THAT RAYMOND READ AND MICHELLE DOLLAR, DO HEREBY DECLARE THEY ARE THE OWNERS OF THE LAND DESCRIBED IN THE SURVEYORS CERTIFICATE, AND HAVE CAUSED THE SAME TO BE REPLATTED IN ACCORDANCE WITH THE PROVISIONS OF O.R.S. CHAPTER 92, AS SHOWN ON THE ANNEXED PLAT. Raymond S. Read Michelle K. Dollar RAYMOND READ MICHELLE DOLLAR

ACKNOWLEDGMENT

ON 2-19-2014, 2014 BEFORE ME DID PERSONALLY APPEAR THE WITHIN NAMED RAYMOND READ AND MICHELLE DOLLAR, WHO ACKNOWLEDGED TO ME THAT THEY EXECUTED THE SAME FREELY AND VOLUNTARILY.

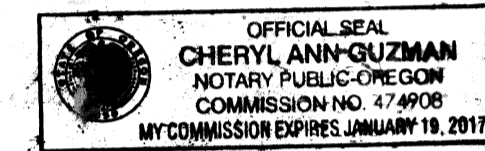

STATE OF OREGON } S.S. NOTARY PUBLIC COUNTY OF BAKER } MY COMMISSION EXPIRES 1-19-17

APPROVALS

WE THE UNDERSIGNED OFFICERS IN AND FOR BAKER COUNTY, OREGON DO HEREBY APPROVE THIS REPLAT. BAKER COUNTY SURVEYOR BY: [Signature] DATE Nov. 26, 2013

BAKER COUNTY PLANNING BY: [Signature] DATE February 24, 2014

I HEREBY CERTIFY THAT ALL TAXES FOR THE SUBJECT PROPERTY HAVE BEEN PAID AS REQUIRED. BAKER COUNTY TAX COLLECTOR BY: [Signature] DATE 3-4-14, 2013

I DO HEREBY CERTIFY THAT THIS REPLAT WAS RECEIVED FOR RECORDING ON THE 4th DAY OF MARCH, 2014 AT 11:00 O'CLOCK A.M., AND RECORDED IN BAKER COUNTY RECORDS AND IS HEREBY APPROVED.

BAKER COUNTY CLERK BY: Tamara J. Green Co. Clerk by Karen Phillips, Deputy

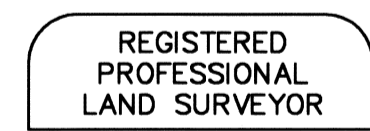

7/27/13 Timothy P Rouse

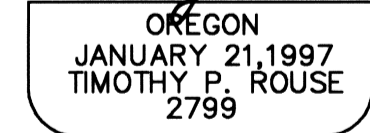

REFERENCES

- SURVEY NO. 11-40-9
SURVEY NO. 11-40-78
SURVEY NO. P1992-002
MINERAL SURVEY NO. 611 "KLONDIKE PLACER"
MINERAL SURVEY NO. 705 "SOUTH PLACER"
BAKER COUNTY DEED REFERENCE 87-42-59
BAKER COUNTY DEED REFERENCE 87-42-63
BAKER COUNTY DEED REFERENCE 88-21-021
BAKER COUNTY DEED REFERENCE 94-43-155
BAKER COUNTY DEED REFERENCE B06-35-0065

SHEET 2 OF 3

Table with 2 columns: Survey Reference and Surveyor Information. Includes 'SURVEY FOR RAYMOND READ & MICHELLE DOLLAR' and 'ROUSE SURVEYING, INC. 4900 N.E. 229TH ST. RIDGEFIELD, WA 98642'.