

C/L POCAHONTAS ROAD

MAJOR PARTITION PLAT No. P2010-009

A Portion of The West 1/2, NW 1/4 of Section 11, & The East 1/2, NE 1/4 of Section 10, Township 9 South, Range 39 East of the Willamette Meridian, Baker County, Oregon Survey Completed June 21, 2010

LOCATION ESTABLISHED BY DOUBLE PROPORTION FROM ROAD CENTERLINES N, S, E & W CORNER RECORD TO BE FILED

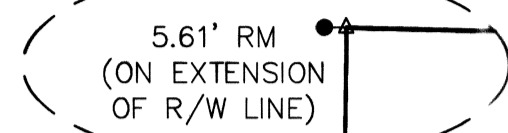

DETAIL: N.T.S.

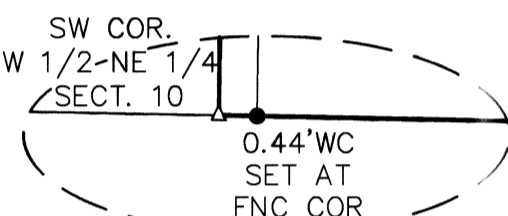

DETAIL: N.T.S.

REGISTERED PROFESSIONAL LAND SURVEYOR

Lawrence H. Koerner OREGON JAN. 29, 2001 LAWRENCE H. KOERNER 64242 7/20/10 EXPIRATION DATE: 6/30/11

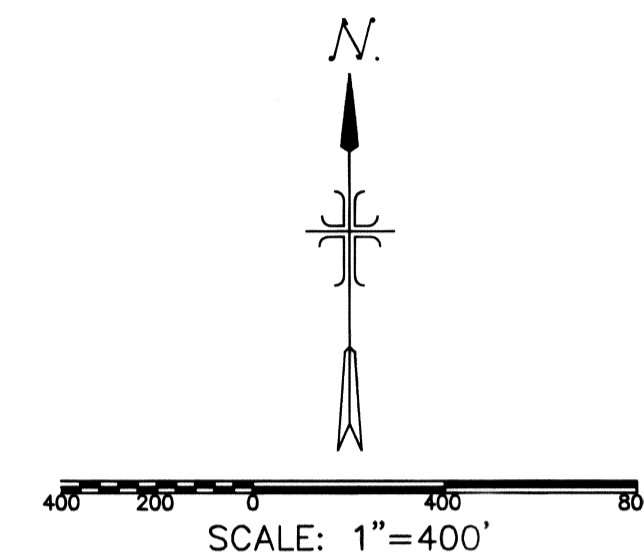

- LEGEND: Boundary Line, Section Line, Existing Fence, Found Brass Cap, Found Aluminum Cap, Found 5/8" Iron Pin, Set 5/8" Iron Pin W/Plastic Cap "Koerner LS 64242", Calculated Point, Reference Monument, Witness Corner

9-10 CORNER RECORD 9-39-255

C 1/4 CORNER SET BY DOUBLE PROPORTION CORNER RECORD TO BE FILED

N00°47'24"E 2647.73'

N00°47'24"E 2625.67'

10-15

CORNER RECORD 9-39-233

LINE TABLE with columns: LINE, BEARING, DISTANCE. Lists lines L1 through L27 with their respective bearings and distances.

CURVE TABLE with columns: CURVE, RADIUS, DELTA ANGLE, LENGTH, TANGENT, CHORD, CHORD BEARING. Lists curves C1 through C10 with their respective parameters.

NARRATIVE

I WAS EMPLOYED BY BETTY GREEN TO COMPLETE THE SURVEY REQUIREMENTS OF THIS APPROVED MAJOR PARTITION PLAT. THE RIGHT OF WAYS FOR POCAHONTAS ROAD AND WASHINGTON GULCH ROAD WERE CREATED FROM LOCATING THE CENTERLINES OF BOTH ROADS AND OFFSETTING THEM 30'. THE BOUNDARIES AROUND THE EXCEPTIONS PARCELS (LISTED IN BARGAIN AND SALE DEED B05 26 0370, 0371 & 0372) WERE CREATED FROM THE RECORD INFORMATION IN SAID DEEDS, AND FROM OCCUPATIONS LINES LOCATED IN THE FIELD. THE CENTER QUARTER CORNER FOR SECTION 10 WAS ESTABLISHED BY DOUBLE PROPORTION FROM THE NORTH, SOUTH, EAST & WEST QUARTER CORNERS. THE SOUTH, WEST & EAST QUARTER CORNERS FOR SECTION 10 WERE LOCATED IN THE FIELD. I SET THE NORTH QUARTER CORNER BY DOUBLE PROPORTION BY THE LOCATING OF THE CENTERLINE OF POCAHONTAS ROAD EAST & WEST OF THE CORNER, AND THE CENTERLINE OF ROUEN ROAD RUNNING SOUTH & OLD WING ROAD RUNNING NORTH OF THE CORNER. I ESTABLISHED THE WEST BOUNDARY LINE OF THIS SURVEY ON THE WESTERLY BOUNDARY LINE OF THE EAST 1/2 NE 1/4 OF SECTION 10, AFTER ESTABLISHING THE NORTH-SOUTH CENTER OF SECTION LINE OF SAID SECTION 10..

Koerner Land Surveying & Planning 2963 W. Fieldstream Dr. Meridian, Idaho 208-830-4168

