

REPLAT NO. P2009-012

BEING A REPLAT OF A PORTION OF BLOCK 10 OF WILOVALE ADDITION TO BAKER CITY AND A PORTION OF VACATED GROVE STREET, SITUATED IN THE SW1/4NW1/4 SECTION 21, T.9S., R.40E., W.M., CITY OF BAKER CITY, BAKER COUNTY, OREGON SURVEY COMPLETED NOVEMBER 6, 2009

B09 48 0313

SURVEYOR'S CERTIFICATE

I, JASON L. HATFIELD, PROFESSIONAL LAND SURVEYOR, REGISTERED IN THE STATE OF OREGON, HEREBY CERTIFY THAT I HAVE CORRECTLY SURVEYED AND MARKED WITH PROPER MONUMENTS THE LAND REPRESENTED AS SHOWN ON THIS REPLAT, SAID REPLAT BEING SITUATED IN THE SW1/4NW1/4 SECTION 21, T.9S., R.40E., W.M., CITY OF BAKER CITY, BAKER COUNTY, OREGON, BEING MORE PARTICULARLY DESCRIBED AS FOLLOWS:

LAND IN BLOCK 10 OF WILOVALE ADDITION TO BAKER CITY AS FOLLOWS:
LOTS 12, 13, 14, 15 AND 16, EXCEPTING THEREFROM THE EAST 32 FEET;
ALL OF LOTS 17, 18, 19, 20 AND 21 AND THE WEST 82 FEET OF LOT 22.

TOGETHER WITH ALL THAT PORTION OF THE VACATED ALLEY THROUGH SAID BLOCK LYING ADJACENT TO LOTS 12 THROUGH 16, SAID ALLEY BEING VACATED BY ORDINANCE NO. 2127, RECORDED APRIL 17, 1938, IN BOOK 125, PAGE 252, DEED RECORDS OF BAKER COUNTY, OREGON.

ALSO TOGETHER WITH 18 FEET OF VACATED GROVE STREET LYING ADJACENT TO LOTS 17 THROUGH 22, VACATED BY ORDINANCE NO. 2127, RECORDED APRIL 17, 1938, IN BOOK 125, PAGE 252, DEED RECORDS OF BAKER COUNTY, OREGON.

SAID REPLAT CONTAINING 27,501 SQUARE FEET, MORE OR LESS.

I DO HEREBY DESIGNATE THE NW CORNER OF LOT 2 OF THIS REPLAT AS THE INITIAL POINT. SAID POINT BEING 550.42 FEET NORTH AND 1033.73 FEET EAST OF THE MONUMENTED EAST 1/4 CORNER OF SECTION 21, T.9S., R.40E., W.M.

JASON L. HATFIELD, PLS #69454
BENCHMARK LAND SURVEYING

SUBJECT TO THE FOLLOWING:

- RIGHTS OF THE PUBLIC IN AND TO ANY PORTION OF THE HEREIN DESCRIBED PREMISES LYING WITHIN THE BOUNDARIES OF STREETS, ROADS OR ALLEYS.
- EASEMENTS, RIGHTS OF WAY OR RESERVATIONS AS THE SAME MAY EXIST OR APPEAR OF RECORD.

NARRATIVE

THIS SURVEY WAS PERFORMED AT THE REQUEST OF ROD WRIGHT, ON BEHALF OF THE WRIGHT TRUST. THE PURPOSE OF THIS SURVEY WAS TO MARK WITH PROPER MONUMENTS, LOTS 1, 2 AND 3 OF THIS REPLAT, AS SHOWN HEREON.

A SEARCH WAS MADE OF THE AVAILABLE RECORDS PERTAINING TO THIS SURVEY. WE MADE FIELD MEASUREMENTS TO LOCATE APPURTENANT MONUMENTS SHOWN ON RECORD MAP OF SURVEY NO.'S 9-40-51BC, 9-40-166, 9-40-170BC, 9-40-222 AND 9-40-336.

MY RESEARCH DISCLOSED THAT EAST STREET WAS ORIGINALLY 20 FEET WIDE. THE EAST 32 FEET OF BLOCK 10 WAS DEDICATED TO THE CITY OF BAKER CITY FOR STREET PURPOSES PER DOCUMENT NO. 7227064, INCREASING THE WIDTH OF EAST STREET TO 52 FEET. RECORD MAP OF SURVEY NO.'S 9-40-170BC, 9-40-222 AND 9-40-336 SHOW A FOUND MONUMENT MARKING THE CENTERLINE INTERSECTION OF THE 52 FOOT WIDE EAST STREET AND INDIANA AVENUE. MAP OF SURVEY NO. 9-40-170BC NOTES THAT A RAILROAD SPIKE WAS FOUND, WHILE THE OTHER TWO MAPS NOTE THAT A STEEL PIN WAS FOUND. WE FOUND A BRIDGE SPIKE AT THIS LOCATION 12" UNDER THE PAVED SURFACE. THE BRIDGE SPIKE IS IN HARMONY WITH THE RECORD SURVEY DATA. THE FOUND MONUMENTS ALONG EAST STREET AND THE IMPROVEMENTS IN THE AREA, THEREFOR I ACCEPT IT. I ACCEPT ALL THE OTHER FOUND CONTROLLING MONUMENTS OF RECORD, AS SHOWN HEREON.

DURING THE COURSE OF THIS SURVEY, THE CITY OF BAKER PUBLIC WORKS DEPARTMENT PLACED CITY MONUMENT CASE AROUND THE FOUND BRIDGE SPIKE.

NEW MONUMENTS WERE SET AT POSITIONS APPROVED BY ROD WRIGHT AND ACCORDING TO THE EVIDENCE FOUND, AS SHOWN HEREON.

REFERENCES

- RECORD MAP OF SURVEY NO.'S 9-40-51BC, 9-40-166, 9-40-170BC, 9-40-222 & 9-40-336
- PLAT OF WILOVALE ADDITION TO BAKER CITY
- ELKHORN PRELIMINARY TITLE REPORT FILE NO. 00018698
- BAKER CITY ORDINANCE NO. 2127
- DEED DOCUMENT NO.'S 9615096, 7227064 AND B0940014

REGISTERED
PROFESSIONAL
LAND SURVEYOR

OREGON
NOVEMBER 30, 2007
JASON L. HATFIELD
#69454
EXPIRES: 6/30/2011

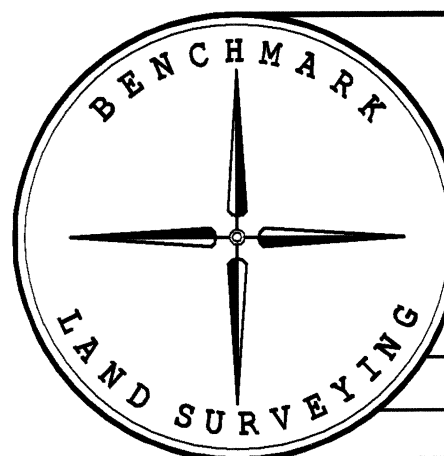

BENCHMARK LAND SURVEYING
217 N. CANYON BLVD. JOHN DAY, OREGON
2101 MAIN STREET, STE 223 BAKER CITY, OREGON
541-575-1251 ~ 800-699-0516

A REPLAT OF A PORTION OF BLOCK 10 OF WILOVALE ADDITION TO BAKER CITY AND A PORTION OF VACATED GROVE STREET, SITUATED IN THE SW1/4NW1/4 SECTION 21, T.9S., R.40E., W.M., CITY OF BAKER CITY, BAKER COUNTY, OREGON

SURVEYED FOR	THE WRIGHT TRUST	
SURVEYED BY	JLH & MCS	11/6/2009
Scale: 1"=40'	Drawn by: JLH	SHEET 2 OF 2

APPROVALS

APPROVED THIS 1st DAY OF DECEMBER, 2009

GARY VAN PATTEN PLS 2162
BAKER CITY SURVEYOR

APPROVED THIS 1 DAY OF December, 2009

MIKE
BAKER CITY PLANNING DIRECTOR

ALL AD VALOREM AND SPECIAL ASSESSMENTS DUE PURSUANT TO LAW HAVE BEEN ASSESSED AND COLLECTED.

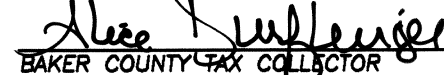
ALEX
BAKER COUNTY TAX COLLECTOR
DATE: 12/1/09

I DO HEREBY CERTIFY THAT THIS PLAT WAS RECEIVED ON THE 1st DAY OF December, 2009 AT 3:35 O'CLOCK P.M., AND RECORDED AS REPLAT NO. P2009-012, BAKER COUNTY RECORDS.

SAMARA J. GREEN Co. Clerk
BAKER COUNTY CLERK
by Karen Phillips, Deputy

DECLARATION

KNOW ALL PEOPLE BY THESE PRESENTS THAT I, DAVID L. WRIGHT, TRUSTEE OF THE WRIGHT TRUST U/A/D JUNE 5, 1986, DO HEREBY DECLARE THAT SAID TRUST IS THE OWNER OF THE LAND DESCRIBED IN THE SURVEYOR'S CERTIFICATE, AND HAS CAUSED THE SAME TO BE REPLATTED IN ACCORDANCE WITH THE PROVISIONS OF ORS CHAPTER 92, AS SHOWN ON THE ANNEXED PLAT.

DAVID L. WRIGHT, TRUSTEE

ACKNOWLEDGMENT

STATE OF OREGON }
COUNTY OF BAKER } SS

THIS INSTRUMENT WAS ACKNOWLEDGED BEFORE ME ON Dec. 1, 2009, BY DAVID L. WRIGHT, TRUSTEE OF THE WRIGHT TRUST U/A/D JUNE 5, 1986

NANCY H. BASCHE
NOTARY PUBLIC FOR OREGON

MY COMMISSION EXPIRES Feb 2, 2011

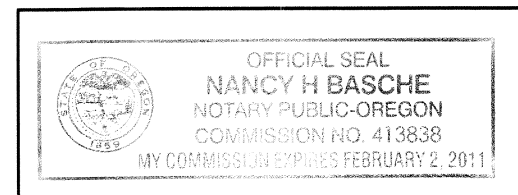

B09 48 0314

B09 48 0315