

LAND PARTITION PLAT NO. 2008-034

BLOCK 32, B.W. LEVEN'S ADDITION TO BAKER CITY,
SITUATED IN THE NW1/4 SECTION 17, T.9S., R.40E., W.M.,
CITY OF BAKER CITY, BAKER COUNTY, OREGON
NOVEMBER 19, 2008

SURVEYOR'S CERTIFICATE

I, JASON L. HATFIELD, PROFESSIONAL LAND SURVEYOR, REGISTERED IN THE STATE OF OREGON, HEREBY CERTIFY THAT I HAVE CORRECTLY SURVEYED AND MARKED WITH PROPER MONUMENTS, PARCEL 1 AND PARCEL 2 OF THIS LAND PARTITION, SAID PARTITION BEING SITUATED IN THE CITY OF BAKER CITY, BAKER COUNTY, OREGON, DESCRIBED AS FOLLOWS:

TWP: 9 S., R. 40 E., W.M.:

SECTION 17:

A TRACT OF LAND SITUATED IN THE NW1/4 DESCRIBED AS FOLLOWS:

ALL OF BLOCK 32, B.W. LEVEN'S ADDITION TO BAKER CITY.

THIS PARTITION CONTAINS 64,837 SQUARE FEET, MORE OR LESS.

I DO HEREBY DESIGNATE THE SE CORNER OF BLOCK 32 AS THE INITIAL POINT OF THIS LAND PARTITION.

BAGETT, GRIFFITH AND BLACKMAN
PROFESSIONAL LAND SURVEYORS
2101 MAIN STREET, SUITE 223
BAKER CITY, OREGON 97814
1-800-699-0516

NARRATIVE

THIS SURVEY WAS PERFORMED AT THE REQUEST OF GREG FLOYD, ON BEHALF OF OLD WEST FEDERAL CREDIT UNION. THE PURPOSE OF THIS SURVEY WAS TO MARK WITH PROPER MONUMENTS, PARCELS 1 AND 2 OF THIS LAND PARTITION, AS SHOWN HEREON.

A SEARCH WAS MADE OF THE AVAILABLE RECORDS PERTAINING TO THIS SURVEY. WE MADE FIELD MEASUREMENTS TO LOCATE APPURTENANT MONUMENTS SHOWN ON RECORD MAP OF SURVEY NO. 9-40-483 AND BAKER CITY SURVEY NO. AD-19-19. THE FOUND MONUMENT AT THE SOUTHWEST CORNER OF BLOCK 32 APPEARED TO BE DISTURBED, AND WAS OUT OF TOLERANCE. WE FOUND THE MONUMENT AT THE NORTHWEST CORNER OF BLOCK 32 TO ALSO BE OUT OF TOLERANCE, BUT IT DID NOT APPEAR TO BE DISTURBED. ALL OTHER APPURTENANT MONUMENTS FROM THESE SURVEYS WERE ACCEPTED, AS SHOWN HEREON.

USING THE RECORD CENTERLINE DATA FROM OREGON STATE HIGHWAY DEPARTMENT DRAWING NO. 48-7-3, I DESIGNATED THE HIGHWAY 30 RIGHT OF WAY BY HOLDING THE MONUMENT AT THE P.C. OF THE CURVE, AND ROTATING THE RECORD CENTERLINE AND RIGHT OF WAY COUNTERCLOCKWISE 00°00'24" TO FIT FOUND MONUMENTS ALONG THE EASTERLY RIGHT OF WAY LINE FROM RECORD SURVEY NO. S. 9-40-109 AND 9-40-483.

NEW MONUMENTS WERE SET AT POSITIONS APPROVED BY GREG FLOYD AND ACCORDING TO THE EVIDENCE FOUND, AS SHOWN HEREON.

APPROVALS

APPROVED THIS 4th DAY OF DECEMBER, 2008
Jason L. Hatfield
PS 2162
BAKER CITY SURVEYOR

APPROVED THIS 4th DAY OF DECEMBER, 2008
Mike DeWitt
BAKER CITY PLANNING DIRECTOR

ALL AD VALOREM AND SPECIAL ASSESSMENTS DUE PURSUANT TO LAW HAVE BEEN ASSESSED AND COLLECTED.
Steve Williams
BAKER COUNTY TAX COLLECTOR
DATE: 12/4/08

I DO HEREBY CERTIFY THAT THIS PLAT WAS RECEIVED ON THE 4th DAY OF DECEMBER, 2008 AT 1:00 O'CLOCK A.M., AND RECORDED AS LAND PARTITION PLAT NO. 2008-034 BAKER COUNTY RECORDS.
Karen Phillips
BAKER COUNTY CLERK

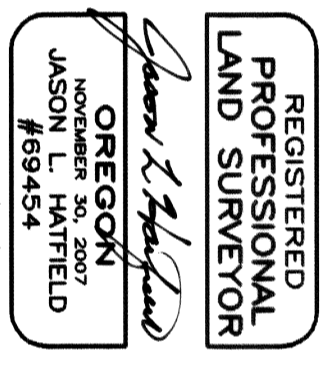

SUBJECT TO THE FOLLOWING:

- 1. RIGHTS OF THE PUBLIC IN AND TO ANY PORTION OF THE HEREIN DESCRIBED PREMISES LYING WITHIN THE BOUNDARIES OF STREETS, ROADS OR HIGHWAYS.
- 2. EASEMENTS, RIGHTS OF WAY AND RESERVATIONS AS THE SAME MAY EXIST OR APPEAR OF RECORD.

REFERENCES

- RECORD MAP OF SURVEY NO.'S 9-40-508C, 9-40-109, 9-40-433 & 9-40-483
- BAKER CITY SURVEY NO. AD-19-18 AND AD-19-19
- O.D.O.I. DRAWING NO. 48-7-3
- DEED RECORD INSTRUMENT NO. 9641038
- PRELIMINARY TITLE REPORT FILE NO. 00018088

DECLARATION

KNOW ALL PEOPLE BY THESE PRESENTS THAT OLD WEST FEDERAL CREDIT UNION, WHO ACQUIRED TITLE AS GRANT-BAKER FEDERAL CREDIT UNION, DOES HEREBY DECLARE THAT SAID CREDIT UNION IS THE OWNER OF THE LAND DESCRIBED IN THE SURVEYOR'S CERTIFICATE, AND HAS CAUSED THE SAME TO BE PARTITIONED INTO PARCELS IN ACCORDANCE WITH THE PROVISIONS OF ORS CHAPTER 92, AS SHOWN ON THE ANNEXED PLAT.

Kenneth Olson
KENNETH OLSON,
PRESIDENT & CEO

ACKNOWLEDGMENT

STATE OF OREGON, SS
COUNTY OF GRANT
THIS INSTRUMENT WAS ACKNOWLEDGED BEFORE ME ON 12/11, 2008,
BY KENNETH OLSON, PRESIDENT & CEO
Kenneth Olson
NOTARY PUBLIC FOR OREGON
MY COMMISSION EXPIRES 5/15/2013

