

EASEMENTS OF RECORD:

Oregon Trail Electric Consumer's Cooperative, Inc. 15 feet wide X 240 feet in length easement for electrical conveyance in Deed 95 37 024, Sept. 7, 1995.

City of Baker 5.77-11.02 feet wide strip for Birch Street widening. Quitclaim Deed 94 15 175, April 15, 1994.

Cascade Natural Gas Corporation 10 feet wide X 506'± in length easement on South boundary of partition for Cathodic Protection purposes Deed 89 30 074, July 12, 1989.

Oregon State Highway Department 10 feet wide along Easterly Boundary for drainage facility purposes.

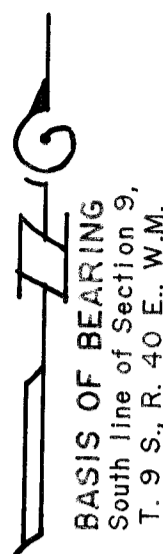

- LEGEND**
- Set 5/8" X 30" rebar with plastic cap marked "HANLEY ENGR. PLS 1206."
 - Found 5/8" X 30" rebar with plastic cap marked "HANLEY ENGR. PLS 1206."
 - ⊙ Found 1/2" rebar with plastic cap marked "HANLEY ENGR."
 - Found O.S.H.D. R/W marker, 5/8" pin with aluminum cap.
 - Found city monument in steel box.

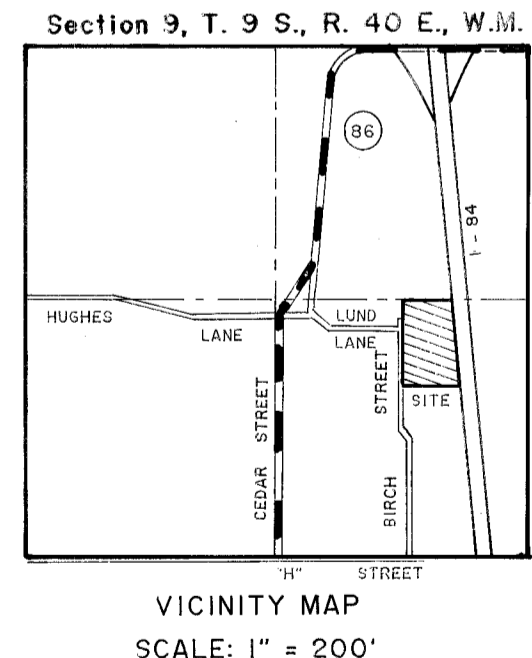

PARTITION PLAT NO. 1996-014
SURVEYOR'S CERTIFICATE

I, James D. Hanley certify that I have correctly surveyed and plotted two parcels of land on the annexed partition map in accordance with O.R.S. Chapter 92. The boundary of the partition is as follows:

A parcel in the E1/2 SE1/4 of Section 9, T. 9 S., R. 40 E., W.M.; All that portion of the Northeast quarter of the Southeast quarter lying West of the West right of way line of U.S. Highway 1-84, and North of the South right of way line of Idlewood Street, as extended Easterly to intersect the West right of way line of said Highway, more particularly described as follows:

Beginning on the North line of the said NE1/4 SE1/4, S. 89° 45' 49" E., 11.02 feet from the Northwest corner thereof; thence S.89° 45' 49" E., 421.84 feet along the said North line to intersect the Westerly right of way line of said highway; thence S. 06° 46' 58" E., 978.61 feet along said right of way line to a point which is the intersection of the extended South line of Idlewood Drive; thence S. 87° 58' 30" W., 505.00 feet along said extended line to the Southeast corner of a variable width strip of land, 5.77 feet wide at the Southernmost end for the purpose of widening Birch Street; thence N. 01° 32' 07" W., 457.23 feet along said Easterly line to a point which is 11.02 feet East of the West line of said NE1/4 SE1/4 and on the extended North line of Cedar Acres Addition; thence N. 02° 11' 39" W., 534.68 feet, 11.02 feet Easterly and parallel to the said West line of NE1/4 SE1/4 to the North line of said NE1/4 SE1/4, the point of beginning.

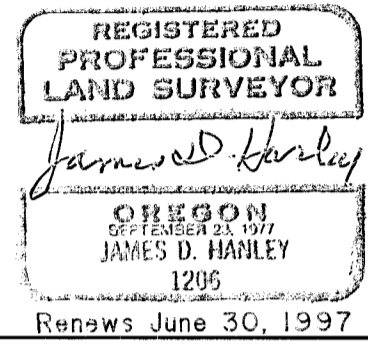

NARRATIVE

The purpose of this survey and plat for Baker Valley Christian Assembly, is to partition a tract of land shown hereon into two parcels and marking on the ground the corners of each. The tract exterior boundary is described in Deed 79 01 100. Controlling monumentation consisting of Southeast corner of Section 9, the Northwest and Southwest corners of NE1/4 SE1/4, Partition P 1996-012 corners, O.S.H.D. references to 1-84 Highway and Idlewood Drive Street were all recovered for this purpose.

DECLARATION

Know all people by these presents that Baker Valley Christian Assembly, a non-profit corporation, is the owner of the land represented on the annexed map, and particularly described in the accompanying Surveyor's Certificate and has caused the same to be partitioned into two parcels as shown, in accordance with O.R.S. Chapter 92.

BAKER VALLEY CHRISTIAN ASSEMBLY, A NON-PROFIT CORPORATION

By Lloyd Phillips, Pres. By Robin Opperman, Secretary
Lloyd Phillips, President Robin Opperman, Secretary

ACKNOWLEDGMENT

State of Oregon } S.S. On July 18, 1996 before me did personally appear the within
County of Baker } named Lloyd Phillips and Robin Opperman who acknowledged to me that
they executed the same freely and voluntarily.

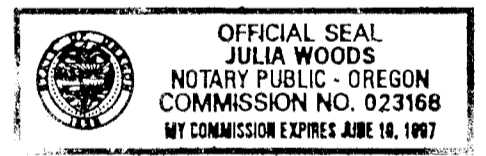

Julia Woods
NOTARY PUBLIC
My Commission Expires 6/18/97

APPROVALS

We the undersigned officers in and for City and County of Baker, Oregon, do hereby approve this minor partition plat.

Baker City Surveyor by: Dary Van Patton PLS 2162

Baker City Planning by: John Callahan, City Attorney

I hereby certify that all taxes for subject property have been paid as required.

Baker County Tax Collector by: Lynne Taylor

State of Oregon } S.S. I do hereby certify that the annexed minor partition plat was
County of Baker } received for record on the 18th day of July, 1996
at 11:15 o'clock P. M., and recorded in Baker County records,
and is hereby approved.

Baker County Clerk by: Julia Woods, Clerk

HANLEY ENGINEERING
2043 MAIN STREET
BAKER CITY, OREGON

SCALE: 1" = 200'